



CDOT EPD Workshop

June 8, 2022



Smarter.
Stronger.
Steel.



Max Puchtel, SE, PE, LEED Green Associate
Director of Government Relations and Sustainability
puchtel@aisc.org

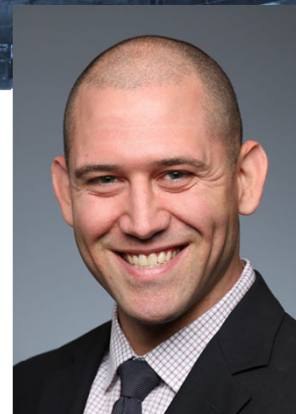

Smarter.
Stronger.
Steel.

Outline

- AISC/NSBA/CRSI
- EPD Landscape





AISC Structural Steel Specialist Market Locations

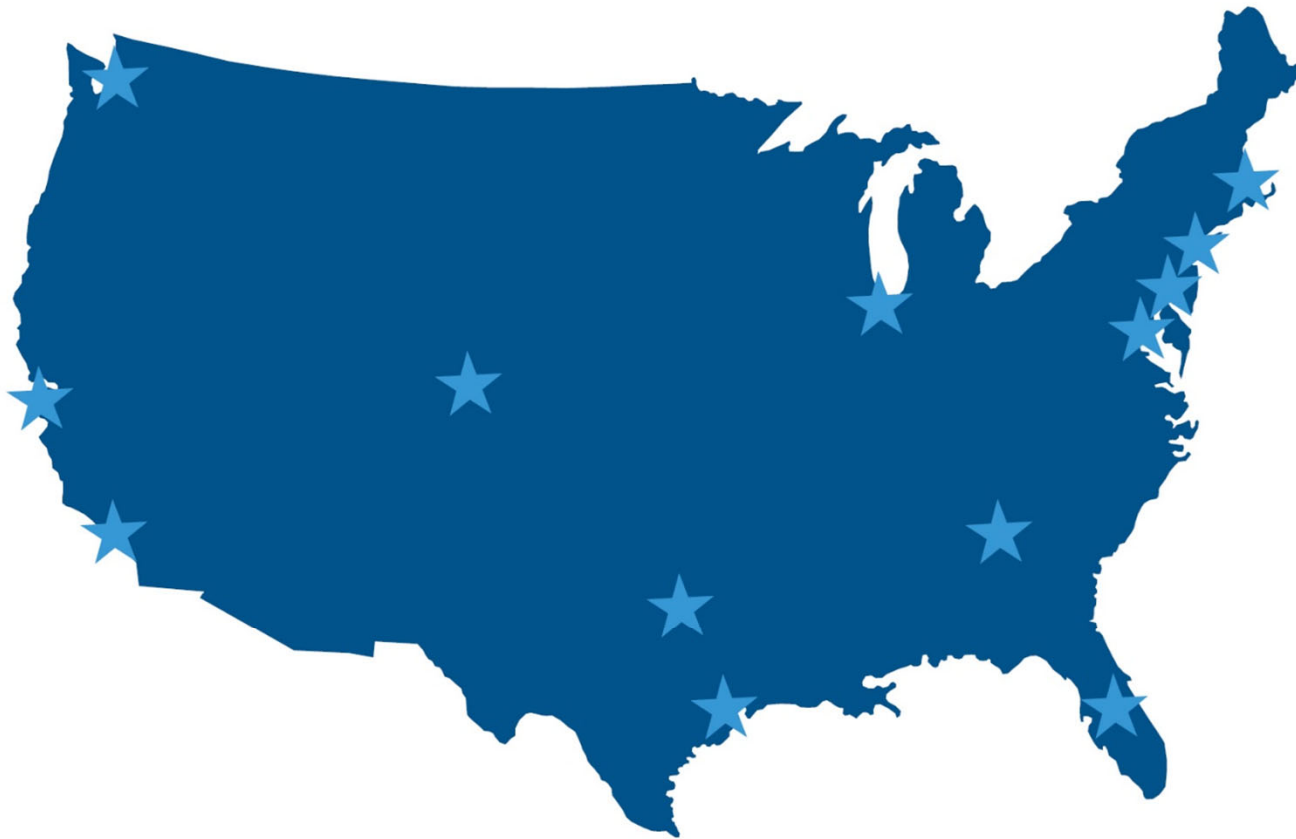

- Atlanta
- Boston
- Central Florida
- Chicago
- Dallas/Fort Worth
- DC/Baltimore
- Denver
- Houston
- Los Angeles
- New York City
- Philadelphia
- San Francisco Bay Area
- Seattle



STEEL SOLUTIONS CENTER

The Steel Solutions Center is your gateway to nearly 100 years of steel knowledge, and it's just a phone call or email away.

.....

aisc.org/askaisc

solutions@aisc.org

866.ASK.AISC



answer your technical questions about structural steel design.



help you understand AISC's technical publications.



help you reduce project risk by connecting decision-makers with AISC-member fabricators for price and schedule information.



provide conceptual solutions for a variety of building types, including framing concepts, lateral systems, column schedules and steel tonnage estimates.

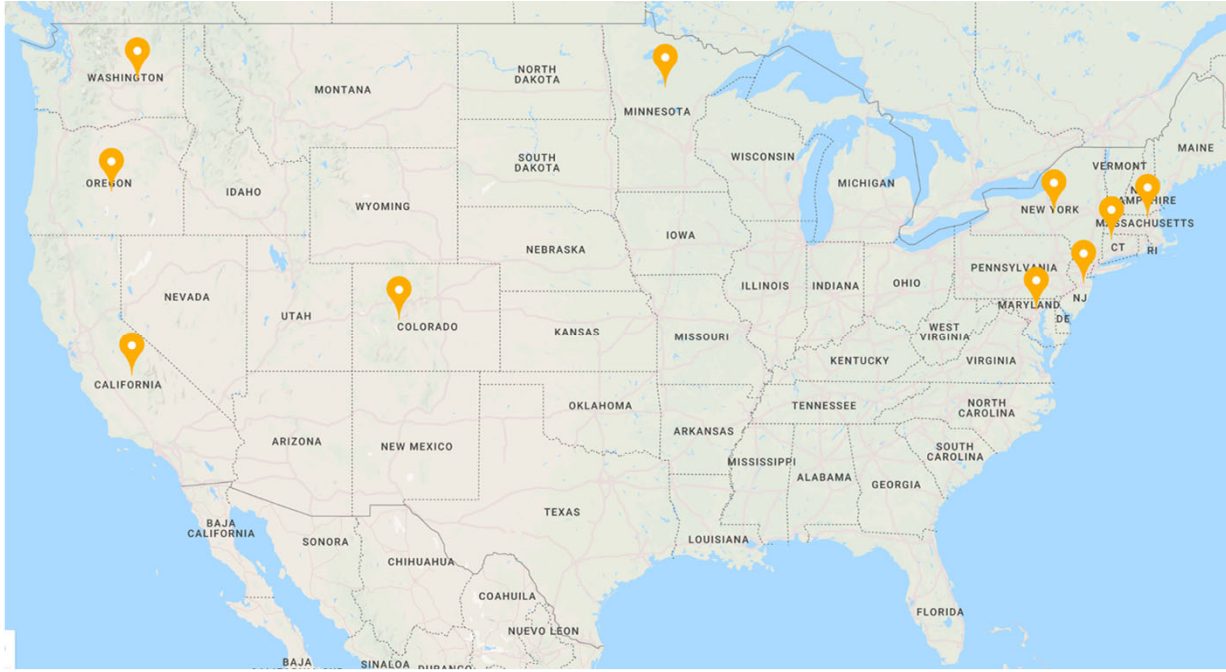

Buy Clean Collaboration





CRSI Concrete Reinforcing Steel Institute



Amy M. R. Trygestad
P.E., F.ACI
Vice President of Engineering
atrygestad@crsi.org
(630) 380-5874



Smarter.
Stronger.
Steel.

Industry-wide EPDs

ENVIRONMENTAL PRODUCT DECLARATION
FABRICATED HOT-ROLLED STRUCTURAL SECTIONS
 AMERICAN INSTITUTE OF STEEL CONSTRUCTION



The United States structural steel industry annually supplies, fabricates and erects structural steel framing for more than 30,000 buildings, bridges and industrial projects through a network of producers, service centers, steel fabricators and erectors.

The National Steel Bridge Alliance, a division of the American Institute of Steel Construction (AISC), is a national, not-for-profit organization dedicated to advancing steel bridge design and construction. NSBA is a unified industry organization of businesses and agencies interested in the development, construction and promotion of cost-effective steel bridges. We represent the entire steel bridge community.

Long committed to the principles of sustainable manufacturing, the industry remains the world leader in the use of recycled materials and end-of-life recycling, with the recycled content of hot-rolled structural beams and columns produced at US mills averaging in excess of 90% and an end-of-life recovery rate of 98%.

The American Institute of Steel Construction is a not-for-profit technical institute and trade association established in 1921 to serve the structural steel design community and construction industry. AISC currently represents 3 producers of hot-rolled structural sections and nearly 1,000 structural steel fabricators in the US.



Hot-rolled structural steel sections complying with the definition of structural steel in ANSI/AISC 303-16 produced in the United States and fabricated by an AISC member fabricator.

Use of this EPD is limited to AISC members. Member names are available online at www.aisc.org/epd

ENVIRONMENTAL PRODUCT DECLARATION
FABRICATED STEEL PLATE
 AMERICAN INSTITUTE OF STEEL CONSTRUCTION



The United States structural steel industry annually supplies, fabricates and erects structural steel framing for more than 30,000 buildings, bridges and industrial projects through a network of producers, service centers, steel fabricators and erectors.

The National Steel Bridge Alliance, a division of the American Institute of Steel Construction (AISC), is a national, not-for-profit organization dedicated to advancing steel bridge design and construction. NSBA is a unified industry organization of businesses and agencies interested in the development, construction and promotion of cost-effective steel bridges. We represent the entire steel bridge community.

Long committed to the principles of sustainable manufacturing, the industry remains the world leader in the use of recycled materials and end-of-life recycling, with the recycled content of steel plate produced at US mills averaging in excess of 80% and an end-of-life recovery rate of 98%.

The American Institute of Steel Construction is a not-for-profit technical institute and trade association established in 1921 to serve the structural steel design community and construction industry. AISC currently represents 3 producers of steel plate and nearly 1,000 structural steel fabricators in the US.



Steel plate complying with the definition of structural steel in ANSI/AISC 303-16 produced in the United States and fabricated by an AISC member fabricator.

Use of this EPD is limited to AISC members. Member names are available online at www.aisc.org/epd

ENVIRONMENTAL PRODUCT DECLARATION
FABRICATED HOLLOW STRUCTURAL SECTIONS
 AMERICAN INSTITUTE OF STEEL CONSTRUCTION
 STEEL TUBE INSTITUTE



The United States structural steel industry annually supplies, fabricates and erects structural steel framing for more than 30,000 buildings, bridges and industrial projects through a network of producers, service centers, steel fabricators and erectors.

Long committed to the principles of sustainable manufacturing, the industry remains the world leader in the use of recycled materials and end-of-life recycling, with the recycled content of steel plate produced at US mills averaging in excess of 80% and an end-of-life recovery rate of 98%.

The American Institute of Steel Construction and its National Steel Bridge Alliance division is a not-for-profit technical institute and trade association established in 1921 to serve the structural steel design community and construction industry for buildings and bridges. AISC currently represents producers of structural sections, plate, and nearly 1,000 structural steel fabricators in the US.

The Steel Tube Institute (STI) was formed in 1930 when a group of manufacturers joined forces to promote and market steel tubing. Their goal was to mount a cooperative effort that would improve manufacturing techniques and inform customers about their products' safety and diversity. The organization is dedicated to the betterment of the steel industry and to the advancement of its member companies.





Shown above are hollow structural sections (HSS) complying with the definition of structural steel in ANSI/AISC 303-16, produced in North America by an STI member, and fabricated by an AISC member fabricator.

Use of this EPD is limited to AISC and STI members. AISC member names are available online at www.aisc.org/epd. STI member names include Atlas Tube, Mansueth American Corporation, Mansueth Lehigh Pipe & Tube, Mansueth Oregon Steel Tube (MOSST), Nucor Tubular Products, Searing Industries, Veeb, Inc., and Westweld Tube.

Environmental Product Declaration
 According to ISO 14025

Fabricated Steel Reinforcement



CRSI Concrete Reinforcing Steel Institute
 Issue Date: August 29, 2017

Use of this EPD is limited to CRSI members. Member names are available online at www.crsi.org/index.cfm?epd

Valid Until: August 28, 2022

Declaration Number: 070

Copyright ASCE International, 300 Star Harbor Drive, PO Box C700, West Conshohocken, PA 19380-2000, United States.

Declaration Number: 070

But these are not acceptable under the Buy Clean CO Act





Who makes domestic structural HRS?



Smarter.
Stronger.
Steel.

NUCOR®



GERDAU



Steel Dynamics®



Smarter.
Stronger.
Steel.



**Who
makes
domestic
structural
plate?**



**Smarter.
Stronger.
Steel.**

NUCOR[®]



CLIFFS

SSAB



**Smarter.
Stronger.
Steel.**

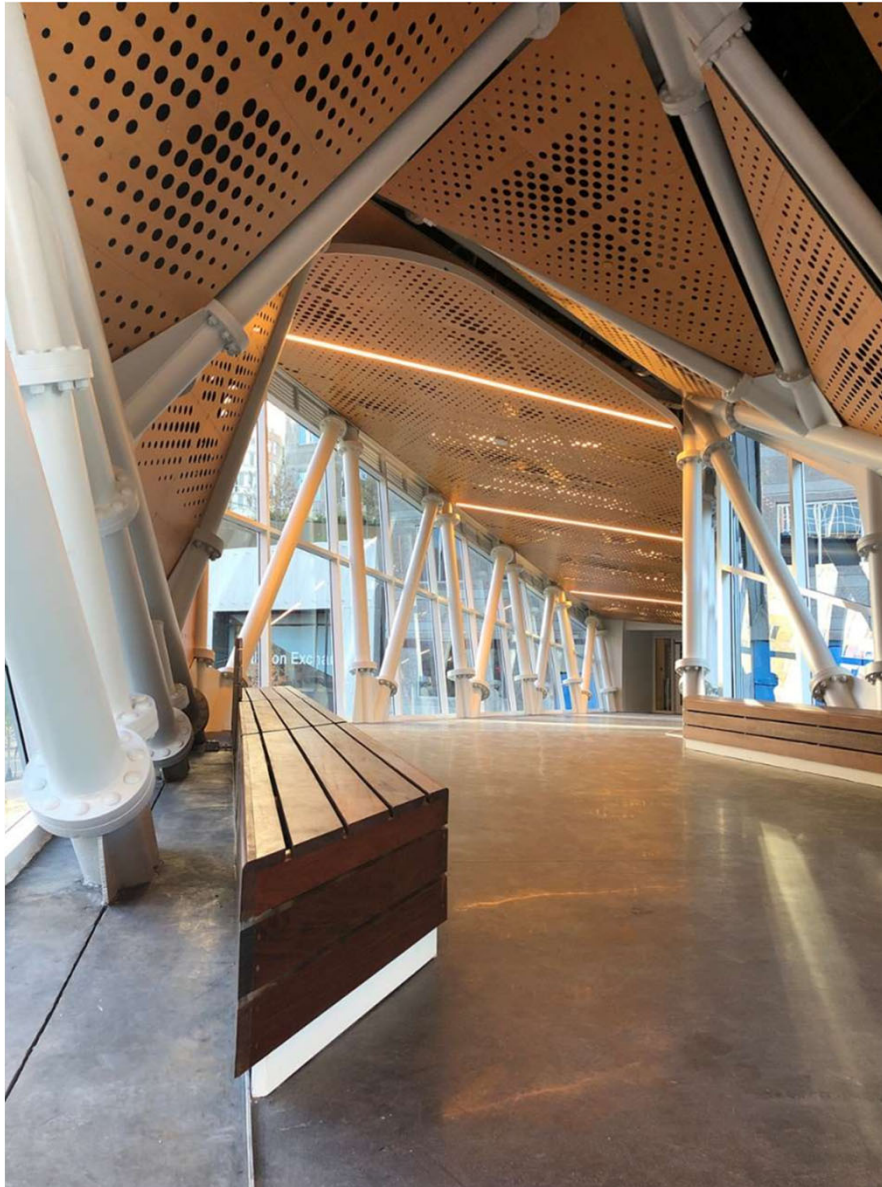

**Who
makes
domestic
structural
HSS?**



**Smarter.
Stronger.
Steel.**

NUCOR®

 **Atlas** *Tube*

 **STEEL TUBE
INSTITUTE**



Smarter.
Stronger.
Steel.

What will you see in the EPD landscape?

- **Data gaps. Consider accepting IW EPDs in the meantime.**
- **Different scopes! A1, A2, A3 mean different things depending on the LCA perspective. All are ok for disclosure purposes, but very close attention must be paid when crafting future policy**



**Smarter.
Stronger.
Steel.**

Principles for Buy Clean Policies

- Recognize that many products are made from steel, but only some are structural steel
- Distinguish between the 3 major product types of structural steel
- Focus requirements on high impact areas
- Include all relevant materials
- Enable consistent comparisons
 - Scope
 - PCRs



Smarter.
Stronger.
Steel.

Principles for Buy Clean Policies

- And many more, but that is down the road for CDOT implementation...



Smarter.
Stronger.
Steel.



Smarter.
Stronger.
Steel.