



Sheet Revisions		
Date	Description	Initials
mm/dd/yy	XXXXXXXX	XXX

Sheet Revisions		
Date	Description	Initials
mm/dd/yy	XXXXXXXX	XXX

Sheet Revisions		
Date	Description	Initials
mm/dd/yy	XXXXXXXX	XXX

This area is reserved for a digital seal, signature, and date.

Land Survey Control Diagram

Title Sheet

Project Number: XXXXX

Project Location: XXXXX

XXXXX

Project Code:	Last Mod. Date	Subset	Sheet No.
XXXXXX	mm-dd-yy	4.01 to 4.XX	4.01

SURVEYOR STATEMENT (LAND SURVEY CONTROL DIAGRAM)

I, _____, a professional land surveyor licensed in the State of Colorado, do hereby state to the Colorado Department of Transportation this Land Survey Control Diagram was prepared and the field survey it represents was performed under my responsible charge and, based upon my knowledge, information and belief is in accordance with applicable standards of practice defined by Colorado Department of Transportation publications. This statement is not a guaranty or warranty, either expressed or implied.

DEPARTMENT OF TRANSPORTATION STATE OF COLORADO

LAND SURVEY CONTROL DIAGRAM

State Highway XXX MP XX.XX to XX.XX

Section XX

Township X South, Range XX West

of the 6th Principal Meridian

County of XXXXX

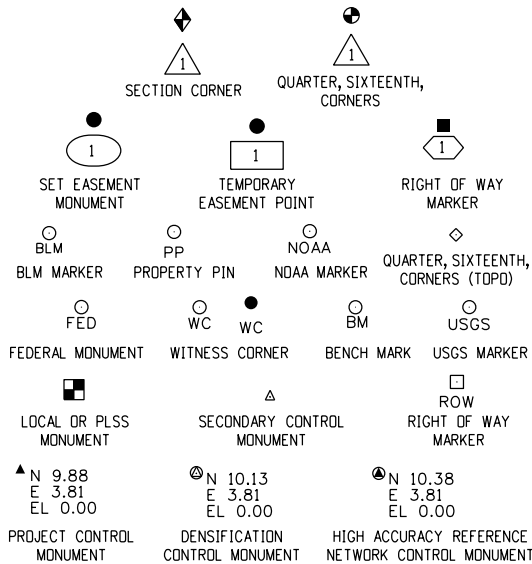

General Notes:

- This Land Survey Control Diagram is not a boundary survey of the adjoining property and is prepared for the Colorado Department of Transportation purposes only. No determination has been made to determine if the found monuments as shown are in their proper position or if they are at the corners they are intended to monument
- Title policy, title commitment, and title research are not part of this survey, therefore easements, rights, and restrictions of record were not researched and are not shown on this diagram. The verification of the physical evidence with relation to easements, rights of ways, property boundaries, and restrictions, as described in the instruments of record, were not included in this land survey control diagram.
- This plan set is subject to change and may not be the most current set. It is the user's responsibility to verify with CDOT that this set is the most current. The information contained on the attached drawing is not valid unless this copy bears an original signature of the Professional Land Surveyor hereon named.
- Refer to the M-629-1 Survey Monuments of the Standard found in The Colorado Department of Transportation, M & S Standards for typical survey monument descriptions.

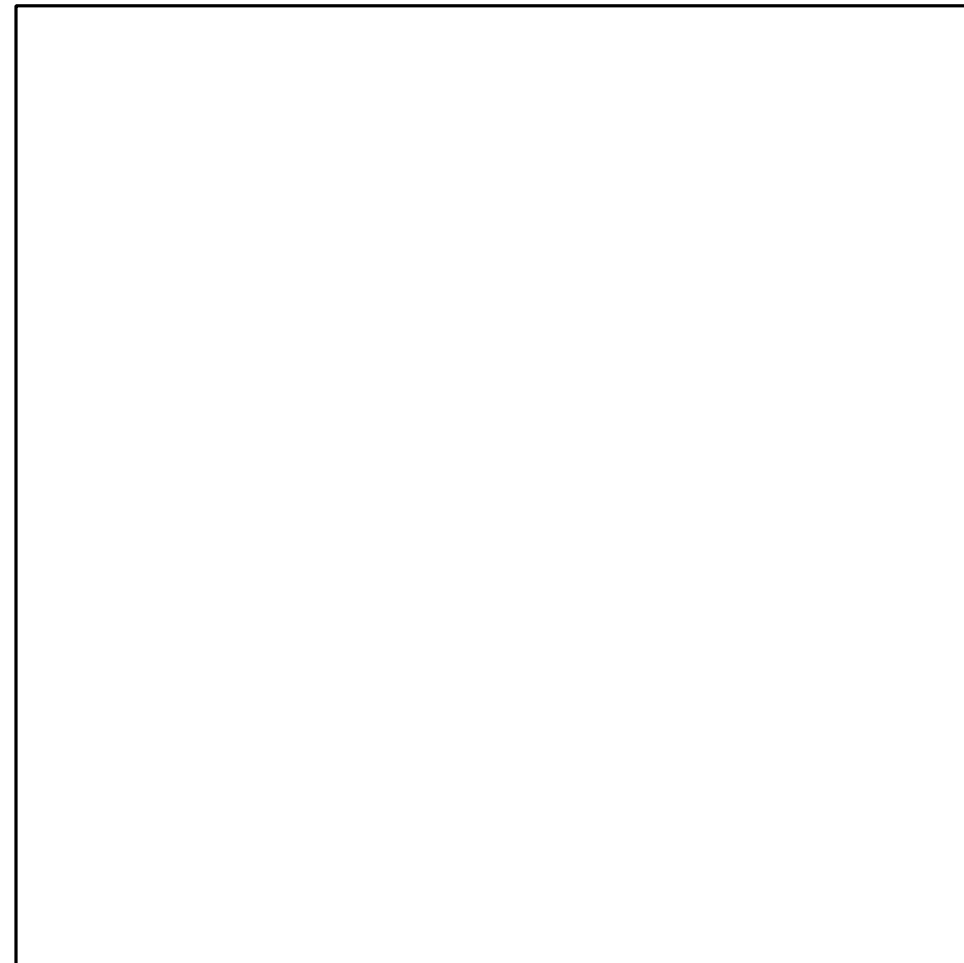

Basis of Bearings: Bearings used in the calculations of coordinates are based on a grid bearing of NXX° XX'XX"W from CM-MP XX.XX to CM-MP XX.XX. Both monuments are CDDT Type II, marked appropriately for their milepost location and control position. The survey data was obtained from a Global Positioning System (GPS) survey base on the Colorado High Accuracy Reference Network (CHARN).

Basis of Elevations: Project elevations are based on Bench Mark XXX 2000, PID: XXXXXX, a standard bench mark disk set on top of a concrete monument, with a NAVD 88 elevation of XXXX.XXft. XXX is a XXXXX order benchmark.

COORDINATE DATUM: Project coordinates are modified Colorado State Plane XXXXXX Zone NAD '83/(XX) coordinates. The combined elevation/scale factor used to modify the coordinates from state plane to project coordinates is 1.XXXXXXXXXXX. The resulting project coordinates are truncated by 200,000m in the Northing and 400,000m in the Easting after converting from state plane coordinates to project coordinates. The CHARN is based on the NAD '83(XX) datum.

Project Coordinates Northing US Survey Feet = (State Plane Coordinate Northing * 1.XXXXXXXXXXX - 200,000) * (3937/1200).

Project Coordinates Easting US Survey Feet = (State Plane Coordinate Easting * 1.XXXXXXXXXXX - 400,000) * (3937/1200).

NOTICE: According to Colorado law you must commence any legal action based upon any defect in this survey within three years after you first discover such defect. In no event may any action based upon any defect in this survey be commenced more than ten years from the date of the certification shown hereon.

Note: For a complete listing of symbology used within this set of plans, please refer to the M-100-1 Standard Symbols of the Colorado Department of Transportation M&S Standards Publication. Existing features are shown as screened weight (gray scale). Proposed or new features are shown as full weight without screening.

PROJECT LOCATION MAP

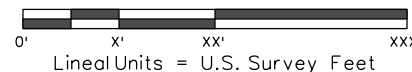

Lineal Units = U.S. Survey Feet



SHEET NO.

- 4.01-4.XX
- 4.XX-4.XX
- 4.XX-4.XX

INDEX OF SHEETS

- (X) Title Sheet
- (X) Monument Coordinate Tables
- (X) Plan Sheet
- (XX) Total Sheets