

Level: ALG_PROPOSED_Hor-Alignment-Sta-Major
Text Style: .07" ENG-100

Level: GEN_ANNO_Text-1
Text Style: .07" ENG-100

Cell: SHEET_Bar-Scale-Horizontal
(General cell library)

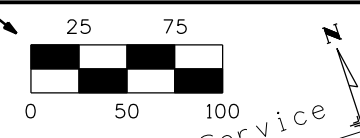

Cell: SHEET_North-Arrow
(General cell library)

Level: GEN_ANNO_Text-1
Text Style: .10" ENG-100

Level: GEN_SHEET_Match-Line

Level: GEN_SHEET_Match-Line
Text Style: .10" ENG-100

Level: ALG_PROPOSED_Ver-Alignment
Text Style: .07" ENG-100

Border is placed by InRoads PnP Generator
Cell: SHEET_Design-PnP-Sheet
(General cell library)

Level: DES_PROFILE_Annotation
Text Style: .07" ENG-100

Level: DES_PROFILE_Grid-Minor

Level: DES_PROFILE_Grid

Level: DES_PROFILE_Grid-Text
Text Style: .07" ENG-100

Level: ALG_PROPOSED_Ver-Alignment-Dim
Text Style: .07" ENG-100

Level: DES_PROFILE_Existing-Ground

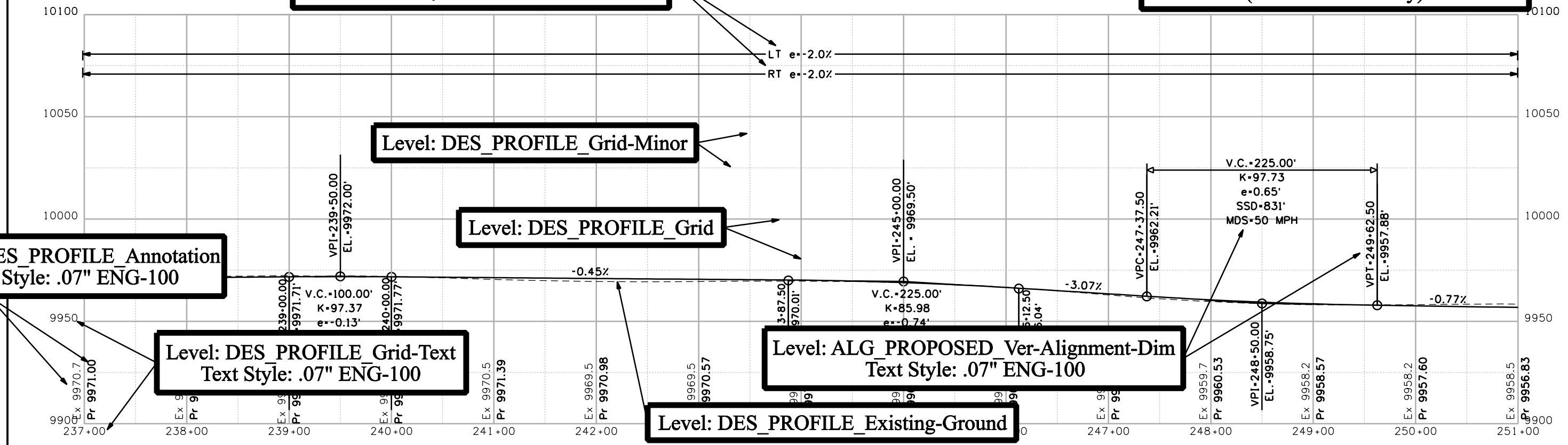

Print Date: 7/12/2006		Sheet Revisions		Colorado Department of Transportation		As Constructed		Project No./Code	
Drawing File Name: Sample_PlanProfile.dgn		Date:	Comments	Init.	Region 3		STA 237+00 to STA 251+00		Project Number
Horiz. Scale: 1:100						No Revisions:		Code	
Unit Information						Revised:		Sheet Number	
Unit Leader Initials						Void:		023	
						Designer: MLM Detailer: MLM Sheet Subset: P&P		Structure Numbers: X-XX-XX Subset Sheets: 3 of 7	

Place Resident
Engineer Cell Here