

B-504-A1
(This sheet must be accompanied with B-504-H1)

Revision Dates
09-16
10-24

INITIALS	DESIGN	DATE	DETAIL	DATE	QUANTITY	DATE
By						
Checked By						

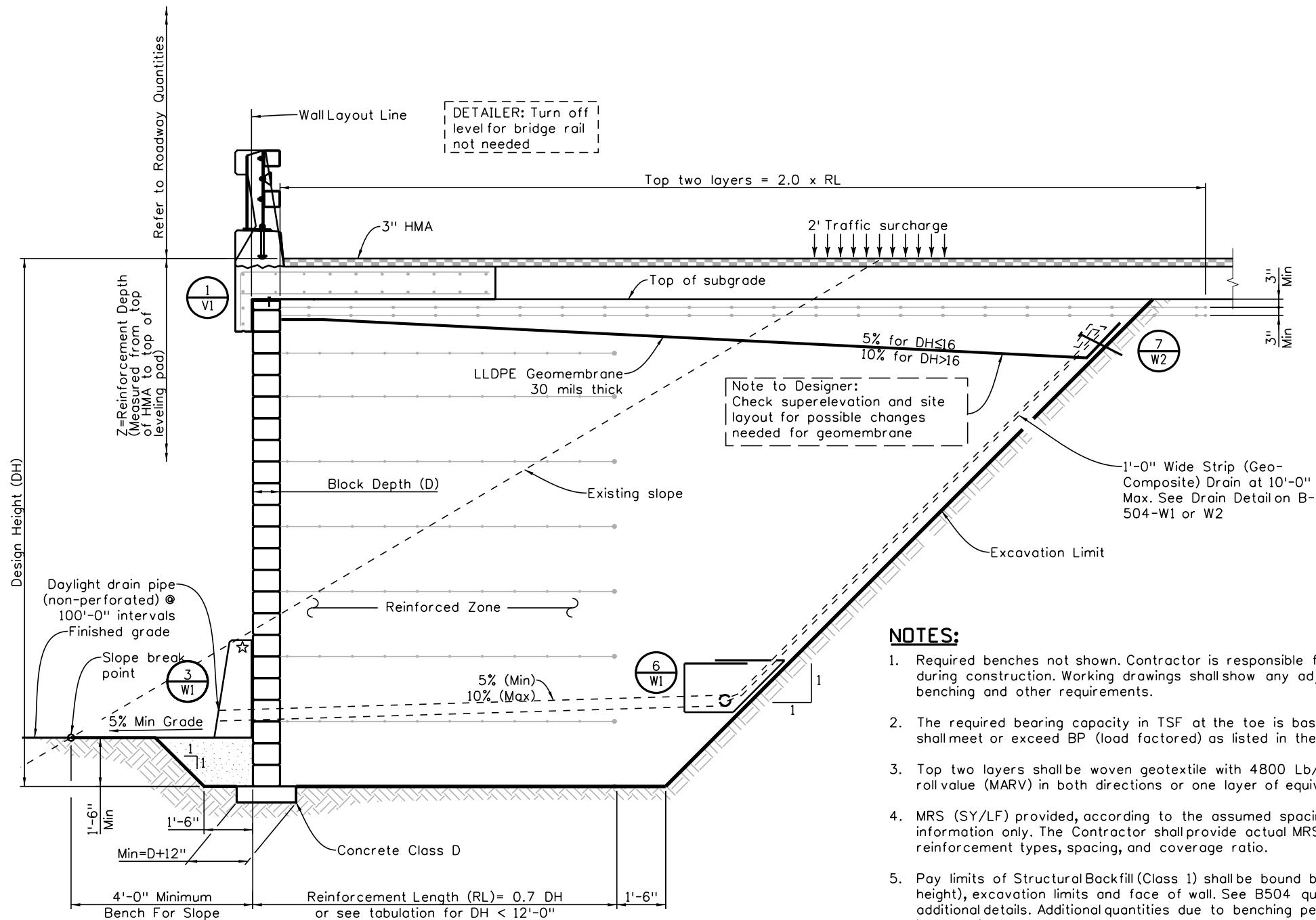

☆ Barrier required when located within clear zone. See M-606-15 Style CD for details.

SECTION VIEW

NOTES:

1. Required benches not shown. Contractor is responsible for slope stability during construction. Working drawings shall show any adjustments needed for benching and other requirements.
2. The required bearing capacity in TSF at the toe is based on 0.7 DH and shall meet or exceed BP (load factored) as listed in the table.
3. Top two layers shall be woven geotextile with 4800 Lb/Ft minimum average roll value (MARV) in both directions or one layer of equivalent geogrid.
4. MRS (SY/LF) provided, according to the assumed spacings in B-504-H1, for information only. The Contractor shall provide actual MRS (SY/LF), soil reinforcement types, spacing, and coverage ratio.
5. Pay limits of Structural Backfill (Class 1) shall be bound by top of DH (design height), excavation limits and face of wall. See B504 quantity sheets for additional details. Additional quantities due to benching per 203.06 shall be included in the cost of the work.

DH (Ft)	RL** (Ft)	MRS (CY/LF)	MRS (SY/LF)	BM1 (CY/LF)	PLG (Ft/LF)	BP (TSF)
2.000	6.000	0.444	2.667	0.755	9.500	0.448
2.667	6.000	0.593	3.333	0.997	10.167	0.513
3.333	6.000	0.741	3.333	1.257	10.833	0.583
4.000	6.000	0.889	4.000	1.532	11.500	0.657
4.667	6.000	1.037	4.000	1.825	12.167	0.737
5.333	6.000	1.185	4.000	2.133	12.833	0.824
6.000	6.000	1.333	4.000	2.458	13.500	0.920
6.667	7.000	1.728	5.444	3.047	15.167	0.966
7.333	7.000	1.901	5.444	3.430	15.833	1.063
8.000	8.000	2.370	6.222	4.125	17.500	1.108
8.667	8.000	2.568	6.222	4.565	18.167	1.206
9.333	8.000	2.765	7.111	5.022	18.833	1.312
10.000	8.000	2.963	7.111	5.495	19.500	1.427
10.667	8.000	3.160	7.111	5.985	20.167	1.554
11.333	8.000	3.358	7.111	6.491	20.833	1.693
12.000	8.400	3.733	8.400	7.192	21.900	1.775
12.667	8.867	4.160	8.867	7.960	23.033	1.846
13.333	9.333	4.609	9.333	8.767	24.167	1.917
14.000	9.800	5.081	10.889	9.614	25.300	1.988
14.667	10.267	5.577	11.407	10.500	26.433	2.059
15.333	10.733	6.095	11.926	11.426	27.567	2.130
16.000	11.200	6.637	13.689	12.392	28.700	2.202
16.667	11.667	7.202	14.259	13.397	29.833	2.273
17.333	12.133	7.789	14.830	14.441	30.967	2.344
18.000	12.600	8.400	16.800	15.525	32.100	2.415
18.667	13.067	9.034	17.422	16.648	33.233	2.487
19.333	13.533	9.691	18.044	17.811	34.367	2.558
20.000	14.000	10.370	20.222	19.014	35.500	2.629
20.667	14.467	11.073	20.896	20.256	36.633	2.700
21.333	14.933	11.799	21.570	21.537	37.767	2.772
22.000	15.400	12.548	23.956	22.858	38.900	2.843
22.667	15.867	13.320	24.681	24.219	40.033	2.914
23.333	16.333	14.115	25.407	25.619	41.167	2.986
24.000	16.800	14.933	28.000	27.058	42.300	3.057
24.667	17.267	15.774	28.778	28.537	43.433	3.129
25.333	17.733	16.639	29.556	30.056	44.567	3.200
26.000	18.200	17.526	32.356	31.614	45.700	3.271
26.667	18.667	18.436	33.185	33.211	46.833	3.343
27.333	19.133	19.370	34.015	34.848	47.967	3.414
28.000	19.600	20.326	37.022	36.525	49.100	3.486
28.667	20.067	21.305	37.904	38.241	50.233	3.557
29.333	20.533	22.308	41.067	39.997	51.367	3.628
30.000	21.000	23.333	42.000	41.792	52.500	3.700
30.667	21.467	24.382	45.319	43.626	53.633	3.771
31.333	21.933	25.453	46.304	45.500	54.767	3.843
32.000	22.400	26.548	49.778	47.414	55.900	3.914
32.667	22.867	27.666	50.815	49.367	57.033	3.986
33.333	23.333	28.807	54.444	51.360	58.167	4.057
34.000	23.800	29.970	55.533	53.392	59.300	4.128
34.667	24.267	31.157	59.319	55.463	60.433	4.200
35.333	24.733	32.367	60.459	57.574	61.567	4.271
36.000	25.200	33.600	64.400	59.725	62.700	4.343
36.667	25.667	34.856	68.444	61.915	63.833	4.414
37.333	26.133	36.135	72.593	64.145	64.967	4.486
38.000	26.600	37.437	76.844	66.414	66.100	4.557
38.667	27.067	38.762	81.200	68.723	67.233	4.629
39.333	27.533	40.110	85.659	71.071	68.367	4.700
40.000	28.000	41.481	90.222	73.458	69.500	4.772

** RL for top two geotextile layers = 2 x RL

*** For example spacing on B-504-H1: DH=16' requires 13.689 SY/LF reinforcement corresponding to 6.637 CY/LF volume of MRS with Class 1 backfill paid separately.

All seals for this set of drawings are applied to the cover page(s)	Print Date: \$DATE\$	Sheet Revisions			Colorado Department of Transportation 2829 West Howard Place, 3rd Floor Denver, CO 80204 Phone: 303-512-4079 FAX: 303-757-9197 Staff Bridge Branch	As Constructed No Revisions: Revised: Void:	RAIL ANCHOR SLAB WITH BLOCK FACING MSE WALL 1:1 SOIL EXCAVATION OR FILL			Project No./Code Sheet Number
	File Name: Sheet_B-504-A1.dgn	Date:	Comments	Init.			Designer: XXXXXXXX	Structure Numbers	XXXXXXXXXXXXX	
	Horiz. Scale: Vert. Scale: As Noted						Detailer: XXXXXXXX		XXXXXXXXXXXXX	
	Unit Information Unit Leader Initials						Sheet Subset: WALL	Subset Sheets: WXX of XXX		