

B-504-N1

(This sheet must be accompanied with B-504-03 or 04)

DH (FT)	RL** (FT)	MRS (CY/LF)	MRS (SY/LF)	BM1 (CY/LF)	PLG (Ft/LF)	03 BP (TSF)	04 BP (TSF)
2.000	6.000	0.444	3.111	0.755	9.500	0.335	1.083
2.667	6.000	0.593	3.778	0.997	10.167	0.409	1.179
3.333	6.000	0.741	4.222	1.257	10.833	0.489	1.290
4.000	6.000	0.889	4.889	1.532	11.500	0.575	1.419
4.667	6.000	1.037	5.333	1.825	12.167	0.669	1.568
5.333	6.000	1.185	6.000	2.133	12.833	0.771	1.740
6.000	6.000	1.333	6.444	2.458	13.500	0.884	1.942
6.667	7.000	1.728	8.000	3.047	15.167	0.973	1.859
7.333	7.000	1.901	8.444	3.430	15.833	1.091	2.042
8.000	8.000	2.370	10.222	4.125	17.500	1.178	1.982
8.667	8.000	2.568	10.667	4.565	18.167	1.301	2.151
9.333	8.000	2.765	11.556	5.022	18.833	1.435	2.341
10.000	8.000	2.963	12.000	5.495	19.500	1.581	2.557
10.667	8.000	3.160	12.889	5.985	20.167	1.742	2.804
11.333	8.000	3.358	13.333	6.491	20.833	1.918	3.091
12.000	8.400	3.733	14.756	7.192	21.900	2.042	3.151
12.667	8.867	4.160	16.363	7.960	23.033	2.156	3.176
13.333	9.333	4.609	18.074	8.767	24.167	2.269	3.207
14.000	9.800	5.081	19.889	9.614	25.300	2.383	3.244
14.667	10.267	5.577	21.807	10.500	26.433	2.496	3.285
15.333	10.733	6.095	23.830	11.426	27.567	2.610	3.329
16.000	11.200	6.637	25.956	12.392	28.700	2.723	3.377
16.667	11.667	7.202	28.185	13.397	29.833	2.837	3.427
17.333	12.133	7.789	30.519	14.441	30.967	2.950	3.479
18.000	12.600	8.400	32.956	15.525	32.100	3.064	3.532
18.667	13.067	9.034	35.496	16.648	33.233	3.177	3.588
19.333	13.533	9.691	38.141	17.811	34.367	3.290	3.645
20.000	14.000	10.370	40.889	19.014	35.500	3.404	3.703
20.667	14.467	11.073	43.741	20.256	36.633	3.517	3.762
21.333	14.933	11.799	46.696	21.537	37.767	3.631	3.822
22.000	15.400	12.548	49.756	22.858	38.900	3.744	3.882
22.667	15.867	13.320	52.919	24.219	40.033	3.858	3.944
23.333	16.333	14.115	56.185	25.619	41.167	3.971	4.006
24.000	16.800	14.933	59.556	27.058	42.300	4.085	4.069
24.667	17.267	15.774	63.030	28.537	43.433	4.198	4.133
25.333	17.733	16.639	66.607	30.056	44.567	4.312	4.197
26.000	18.200	17.526	70.289	31.614	45.700	4.425	4.261
26.667	18.667	18.436	74.074	33.211	46.833	4.539	4.326
27.333	19.133	19.370	77.963	34.848	47.967	4.652	4.391
28.000	19.600	20.326	81.956	36.525	49.100	4.765	4.456
28.667	20.067	21.305	86.052	38.241	50.233	4.879	4.522
29.333	20.533	22.308	90.252	39.997	51.367	4.992	4.588
30.000	21.000	23.333	94.556	41.792	52.500	5.106	4.655
30.667	21.467	24.382	98.963	43.626	53.633	5.219	4.721
31.333	21.933	25.453	103.474	45.500	54.767	5.333	4.788
32.000	22.400	26.548	108.089	47.414	55.900	5.446	4.855
32.667	22.867	27.666	112.807	49.367	57.033	5.560	4.923
33.333	23.333	28.807	117.630	51.360	58.167	5.673	4.990
34.000	23.800	29.970	122.556	53.392	59.300	5.787	5.058
34.667	24.267	31.157	127.585	55.463	60.433	5.900	5.126
35.333	24.733	32.367	132.719	57.574	61.567	6.014	5.194
36.000	25.200	33.600	137.956	59.725	62.700	6.127	5.262
36.667	25.667	34.856	143.296	61.915	63.833	6.241	5.330
37.333	26.133	36.135	148.741	64.145	64.967	6.354	5.399
38.000	26.600	37.437	154.289	66.414	66.100	6.467	5.467
38.667	27.067	38.762	159.941	68.723	67.233	6.581	5.536
39.333	27.533	40.110	165.696	71.071	68.367	6.694	5.605
40.000	28.000	41.481	171.556	73.458	69.500	6.808	5.673

** RL for top two geotextile layers = 2 x RL (For roadway)
RL=PLG (For 2:1 Infinite Slope)

*** For example with reinforcement at each block: DH=16' requires 25.95 SY/LF woven geotextile corresponding to 6.637 CY/LF volume of MRS with Class 1 backfill paid separately

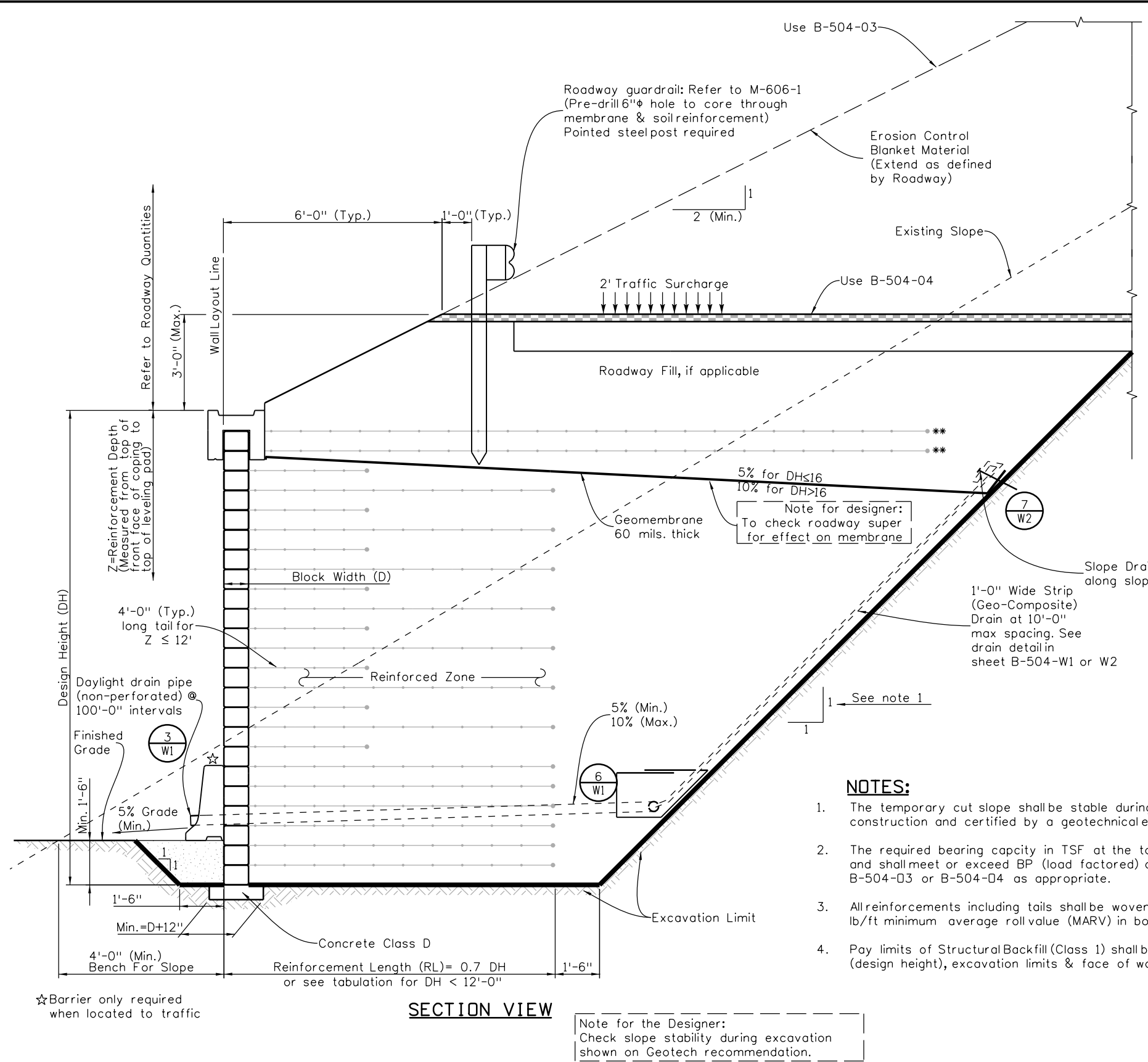

SECTION VIEW

NOTES:

- The temporary cut slope shall be stable during entire period of wall construction and certified by a geotechnical engineer.
- The required bearing capacity in TSF at the toe is based on 0.7 DH and shall meet or exceed BP (load factored) as listed in the table for B-504-03 or B-504-04 as appropriate.
- All reinforcements including tails shall be woven geotextile with 4800 lb/ft minimum average roll value (MARV) in both directions.
- Pay limits of Structural Backfill (Class 1) shall be bound by top of DH (design height), excavation limits & face of wall.

Note for the Designer:
Check slope stability during excavation shown on Geotech recommendation.

Revision Dates	Initial	Date
09-16		

Design		Detail		Quantities	
Designed By	Checked By	INITIAL	DATE	INITIAL	DATE

Print Date: 9/6/2016
File Name: Sheet_B-504-N1.dgn
Horiz. Scale: 1:4 Vert. Scale: As Noted
Staff Bridge Branch-Unit OXXX Unit Leader Initials

Sheet Revisions		
Date:	Comments	Init.

Colorado Department of Transportation
4201 East Arkansas Avenue
Room 107
Denver, CO 80222
Phone: 303-757-9309 FAX: 303-757-9197

Staff Bridge Branch **Initials**

As Constructed
No Revisions:
Revised:
Void:

BLOCK FACING GRS WALL FOR BACKSLOPE OR ROADWAY WITH 1:1 SOIL EXCAVATION			
Designer: XXXXXXXX	Structure Numbers	Wall-X-XX-XX	Project No./Code Project Number Code Sheet Number
Detailer: XXXXXXXX		Wall-X-XX-XX	
Sheet Subset: Wall	Subset Sheets: WXX	of XXX	