

RAIL ANCHOR SLAB WITH CONCRETE ROADWAY AND QUANTITIES

Soil reinforcement not shown for clarity.
(For information only)

ITEM NO.	DESCRIPTION	UNIT	QUANTITY
601	CONCRETE CLASS D	CY/LF	0.31
602	REINFORCING STEEL (EPOXY COATED) fy = 60 ksi	LB/LF	51.00

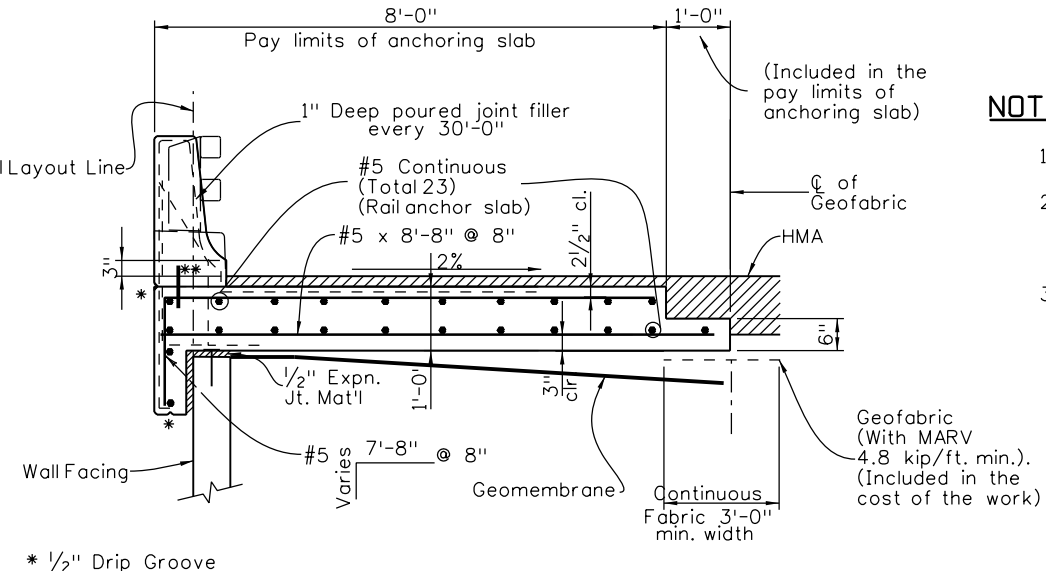

RAIL ANCHOR SLAB WITH ASPHALT ROADWAY AND QUANTITIES

Soil reinforcement not shown for clarity.
(For information only)

Item No.	Description	Unit	Quantity
601	CONCRETE CLASS D	CY/LF	0.33
602	REINFORCING STEEL (EPOXY COATED) fy = 60 ksi	LB/LF	53.00

NOTES:

1. Rail and rail anchor slab shall be a minimum length of 30'-0".
2. A weakened plane with typical 50% longitudinal steel discontinued at 30'-0" spacing shall be placed on both rail and slab for avoiding extended damage.
3. For rail only, at 10'-0" (Max.) spacing a tooled or 1/4" sawcut joint all around shall be included.

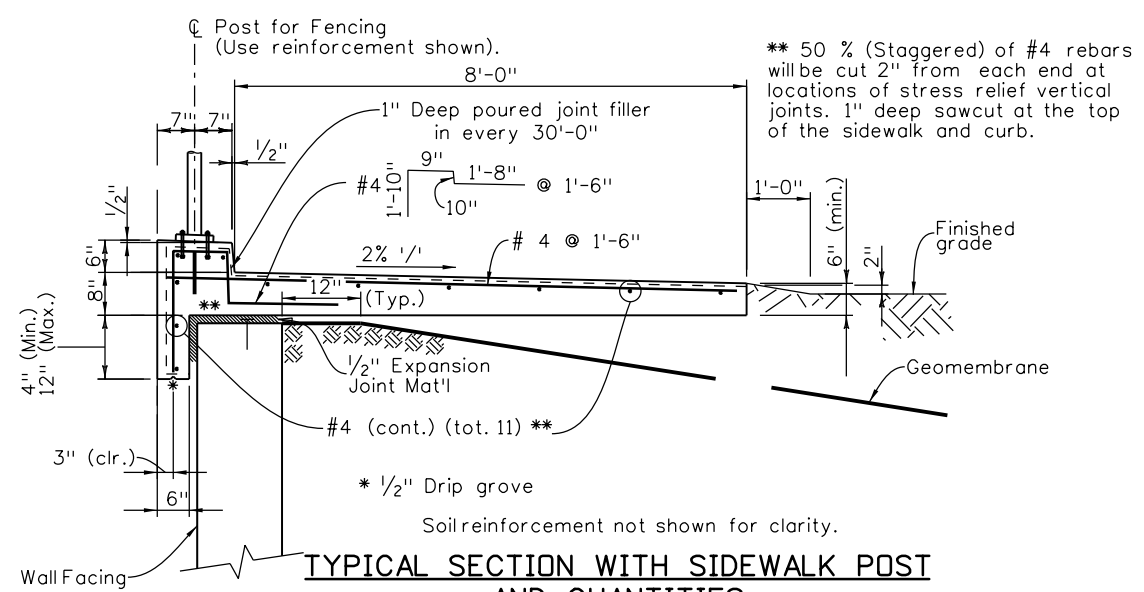

TYPICAL SECTION WITH SIDEWALK POST AND QUANTITIES

Soil reinforcement not shown for clarity.

ITEM NO.	DESCRIPTION	UNIT	w/o GUTTER	w/ GUTTER
601	CONCRETE CLASS D	CY/LF	0.24	0.28
602	REINFORCING STEEL (EPOXY COATED) fy = 60 ksi	LB/LF	14.00	15.20

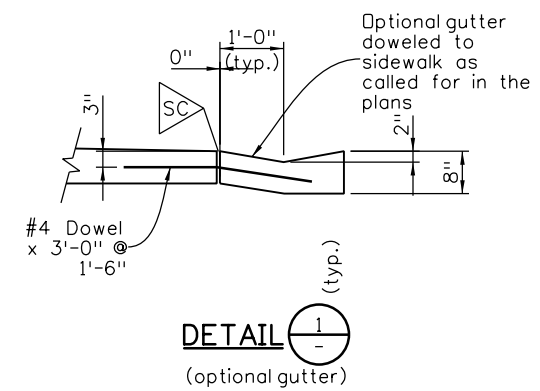

DETAIL 1 (optional gutter)

SC Seal construction joint per M-412-1 for Roadway concrete pavement only.
** Continuous neoprene waterstop with 3" min projection above slab for rail by flow line.

Revision Dates	(Preliminary Stage Only)
09-16	

Design	Detail	Quantities			
INITIAL	DATE	INITIAL	DATE	INITIAL	DATE

Print Date: 9/6/2016	Sheet Revisions			<p>Colorado Department of Transportation 4201 East Arkansas Avenue Room 107 Denver, CO 80222 Phone: 303-757-9309 FAX: 303-757-9197</p>	As Constructed		RAIL ANCHOR SLAB (TYPE 7, TYPE 10M OR SIDEWALK)		Project No./Code	
File Name: Sheet_B-504-V1.dgn	Date:	Comments	Init.		No Revisions:	Designer: XXXXXXXX Structure WALL-X-XX-XX		Project Number		
Horiz. Scale: NTS Vert. Scale: As Noted				Revised:	Detailer: XXXXXXXX Numbers WALL-X-XX-XX		Code			
Staff Bridge Branch-Unit OXXX Unit Leader Initials				Void:	Sheet Subset: Wall Subset Sheets: WXX of XX		Sheet Number			