

| Revision Dates | 9/ 24 |
|----------------|-------|
| 3/23           |       |
| 10/13          |       |
| 3/07           |       |
| 4/02           |       |
| 11/99          |       |
| 3/99           |       |
| 8/95           |       |

| INITIALS   | DESIGN | DATE | DETAIL | DATE | QUANTITY | DATE |
|------------|--------|------|--------|------|----------|------|
| By         |        |      |        |      |          |      |
| Checked By |        |      |        |      |          |      |

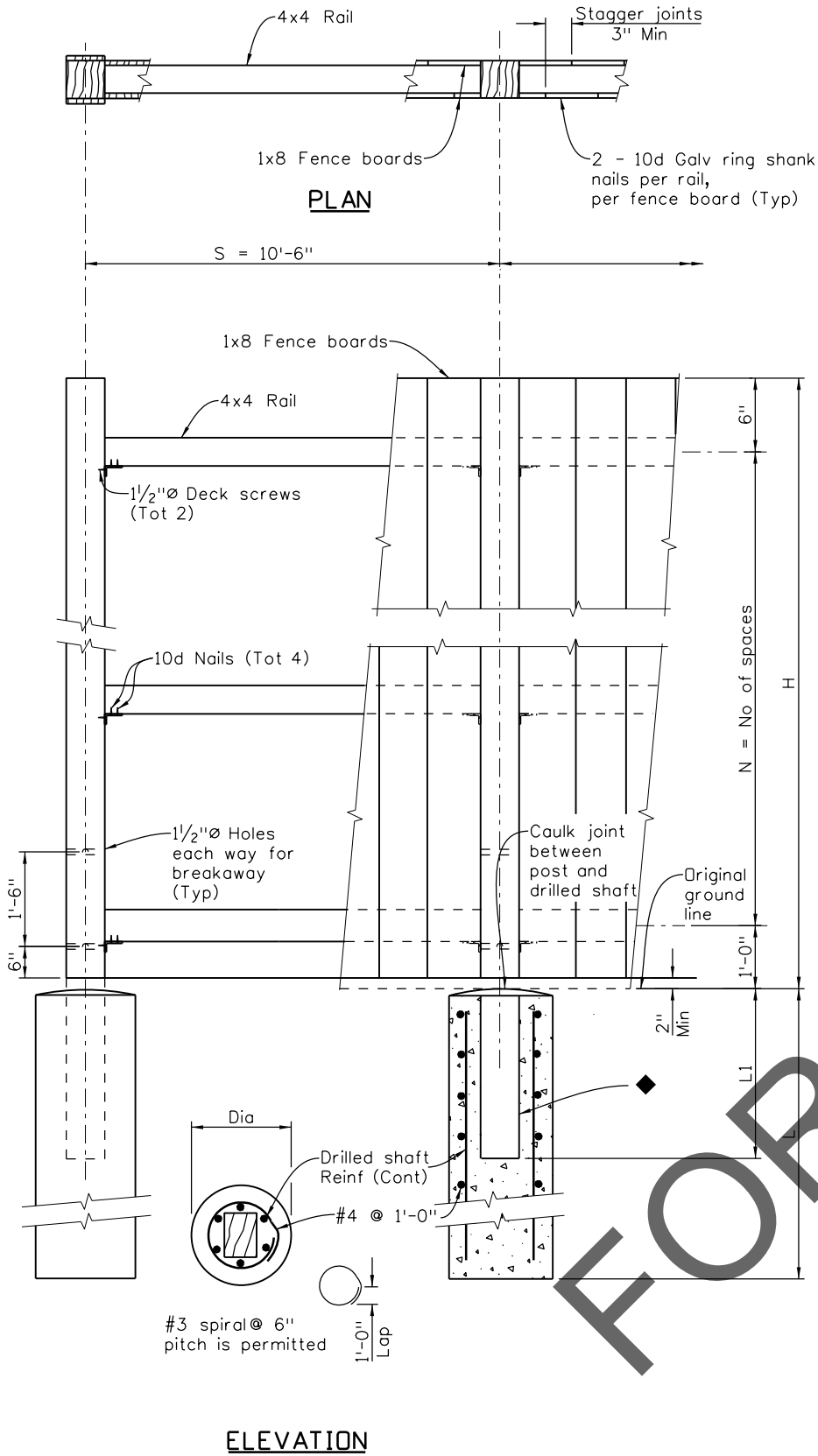

ELEVATION

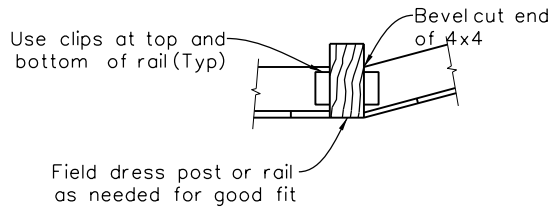

TYPICAL FENCE ANGLE

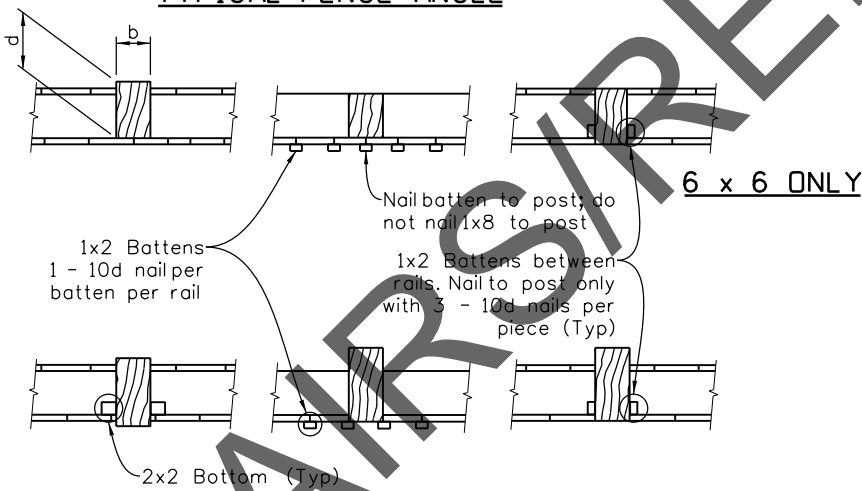

VARIATIONS IN FENCE POST INSTALLATION

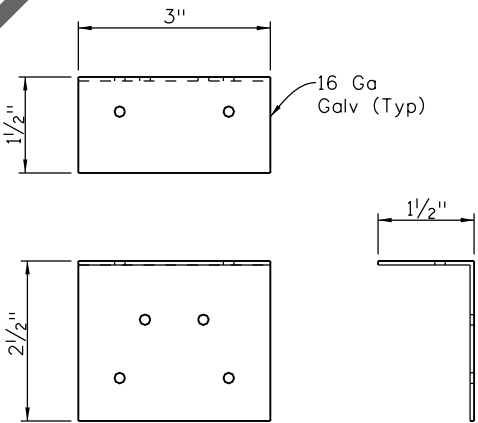

CLIP ANGLE DETAIL

(or approved equal)

NOTES:

1. Timber shall conform to subsection 508.02 of the Standard Specifications with stresses fb = 1000 psi (Min) and fv = 65 psi (Min)
2. All wood dimensions are based on nominal sizes and must be adjusted for dressed material if used.
3. Grade 60 reinforcing steel is required for #4 bars and larger.

DESIGN DATA:

AASHTO Standard Specifications for Structural Design of Sound Barrier, 1989  
Reinforcing steel: #4 bars and larger, fs = 24,000 psi, fy = 60,000 psi  
Wind Load = 12 psf For walls 6'-0" to 15'-0" high  
Class B Concrete fc = 1,200 psi, n = 9

SOIL PARAMETERS FOR DRILLED SHAFT DESIGN:

Compact coarse and fine sand, medium stiff clay weight = 120 Lb/CF, φ = 35°  
Special design is required when the height of the sound barrier exceeds 14'-0"

| Height | Post |     | DRILLED SHAFT |       |       |       | S      | H      | N |
|--------|------|-----|---------------|-------|-------|-------|--------|--------|---|
|        | b    | d   | L▲            | L1▲   | Dia▲  | Reinf |        |        |   |
| 6'-0"  | 6"   | 6"  | 4'-0"         | 3'-0" | 1'-4" | 6#6   | 10'-6" | 6'-0"  | 2 |
| 8'-0"  | 6"   | 6"  | 4'-6"         | 3'-6" | 1'-4" | 6#6   | 10'-6" | 8'-0"  | 3 |
| 10'-0" | 6"   | 8"  | 5'-0"         | 4'-0" | 1'-6" | 6#6   | 10'-6" | 10'-0" | 3 |
| 12'-0" | 6"   | 10" | 5'-6"         | 4'-0" | 1'-8" | 6#6   | 10'-6" | 12'-0" | 4 |
| 14'-0" | 6"   | 10" | 6'-0"         | 4'-0" | 1'-8" | 6#6   | 10'-6" | 14'-0" | 4 |

▲ Minimum

◆ Wrap embedded portion of post in two layers of 90 Lb roofing felt, over one later of 4 mil polyethylene. Hold in place with packaging tape.o

|   |
|---|
| Print Date: \$DATE\$                        |
| File Name: Sheet_B-607-SB1.dgn              |
| Horiz. Scale: None    Vert. Scale: As Noted |
| Unit Information    Unit Leader Initials    |

| Sheet Revisions |          |       |
|-----------------|----------|-------|
| Date:           | Comments | Init. |
|                 |          |       |
|                 |          |       |
|                 |          |       |
|                 |          |       |

Colorado Department of Transportation



2829 West Howard Place, 3rd Floor  
Denver, CO 80204  
Phone: 303-512-4079  
FAX: 303-757-9197

Staff Bridge Branch

Initials

| As Constructed | WOOD SOUND BARRIER (TIMBER POST) |                      |                           |         | Project No./Code |
|----------------|----------------------------------|----------------------|---------------------------|---------|------------------|
|                | No Revisions:                    |                      |                           |         | Project Number   |
| Revised:       | Designer: XXXXXXXX               | Structure Numbers    | X-XX-XX                   | X-XX-XX | Code             |
| Void:          | Detailer: XXXXXXXX               | Sheet Subset: BRIDGE | Subset Sheets: BXX of XXX |         | Sheet Number     |