



Full Weekend Closure - Arapahoe Road

June 17 - June 19

To expedite work and maintain public safety while minimizing long-term impacts to Arapahoe Road drivers, Arapahoe Road will be closed in both directions beneath I-25 the weekend of June 17 to complete Phase 1 of I-25 bridge demolition. The closure will be in effect from 10 p.m. Friday, June 17, until 9 a.m. Sunday, June 19.

While Arapahoe Road is closed for this bridge demolition work, crews will also be relocating utilities and paving. Doing multiple work activities under a single weekend closure will save approximately five nights of overnight closures. Keep in mind that all work is weather dependent and subject to change. Also, this operation may cause noise disturbances.

Traffic Detour

- The eastbound Arapahoe Road on-ramp to southbound I-25 and the westbound Arapahoe Road on-ramp to northbound I-25 will remain open
- Northbound and southbound I-25 off-ramps will remain open; but only right turns are allowed
- Please drive slow, avoid distractions, and watch for signage to guide you through the construction area; alternate routes advised

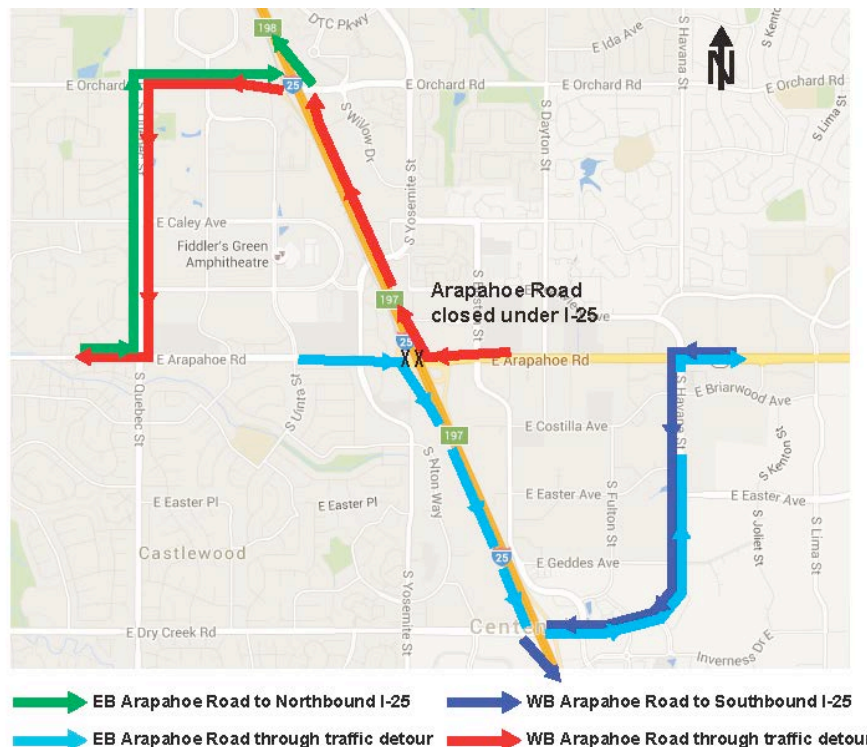



I-25 Arapahoe Interchange Reconstruction

FACT SHEET
June 2016

Pedestrian Detour

- Pedestrians will be detoured via the pedestrian bridge at the Arapahoe light rail station
- For your safety, please watch for signage/flaggers to direct you; do NOT walk through the construction site at any time

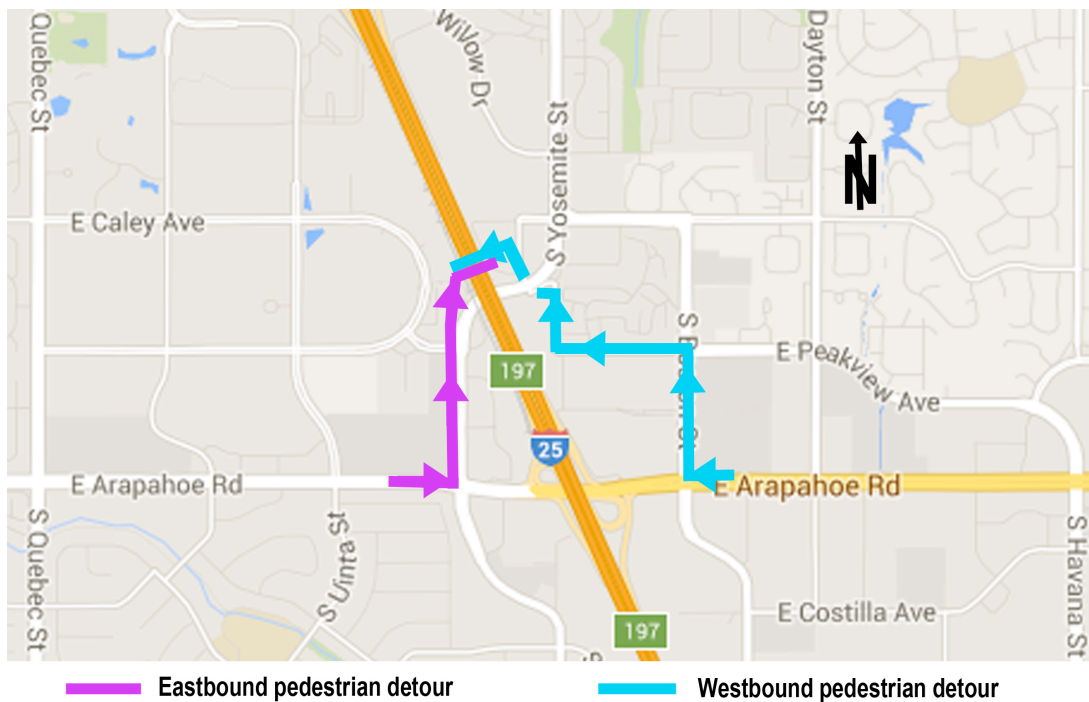

For More Information

Project website: www.codot.gov/projects/I25-Arapahoe

Project hotline: (720) 580-2525

Sign up for project updates by emailing: dot_i25arapahoe@state.co.us

