

CHOOSE YOUR MOVE

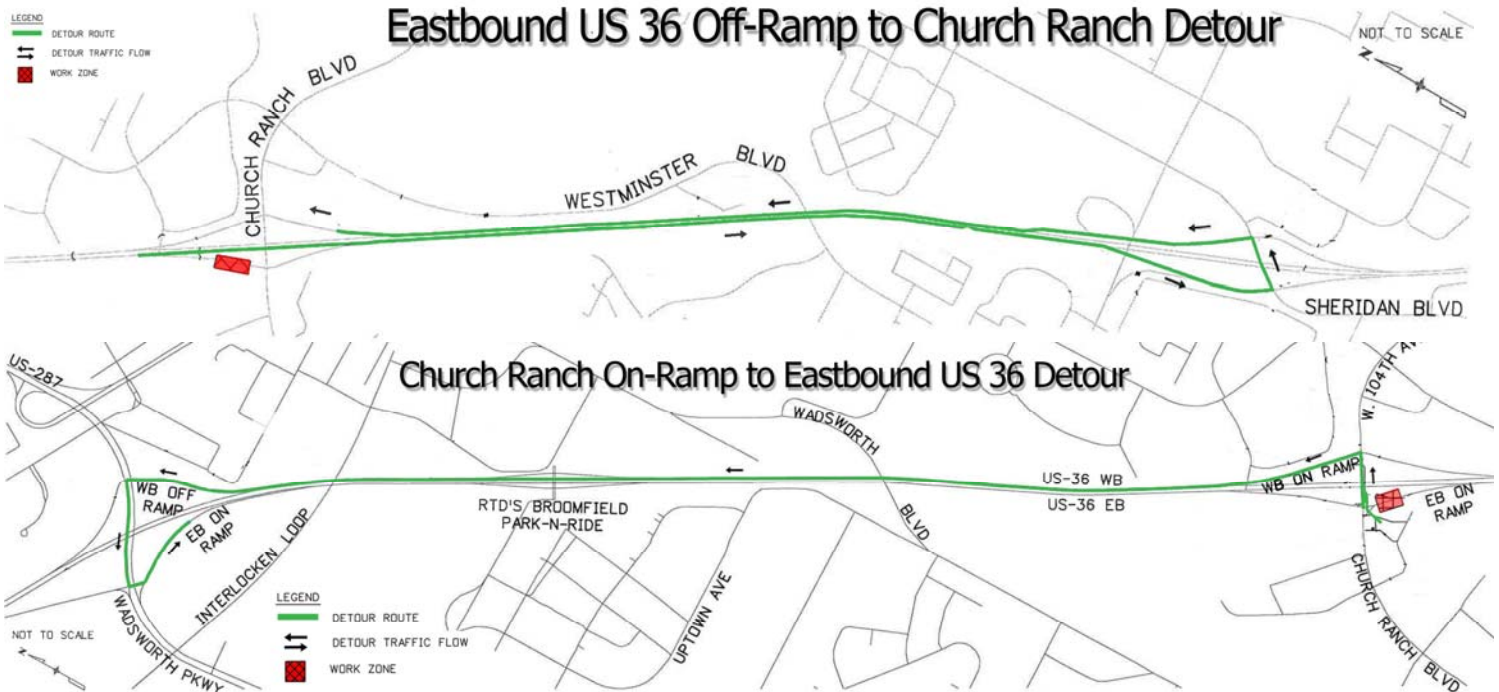

Eastbound US 36 On- and Off-Ramps to Church Ranch Boulevard Closure May 30-June 2

On Friday, May 30, starting at 9 p.m. through 5:30 a.m. on Monday, June 2, the eastbound US 36 on- off-ramps to Church Ranch Boulevard will be closed to all traffic. RTD bus patrons will be directed to use the RTD stops at the US 36 & Broomfield Park-n-Ride at the 1STBank Center, or the Westminster Center Park-n-Ride at Sheridan Boulevard. Traffic will be detoured to Sheridan Boulevard. This closure is necessary to tie the reconstructed ramp into the new eastbound concrete pavement.



For more information, please visit www.us36expresslanes.com or call the project hotline at 303-404-7042.

