

Walls & Amenities

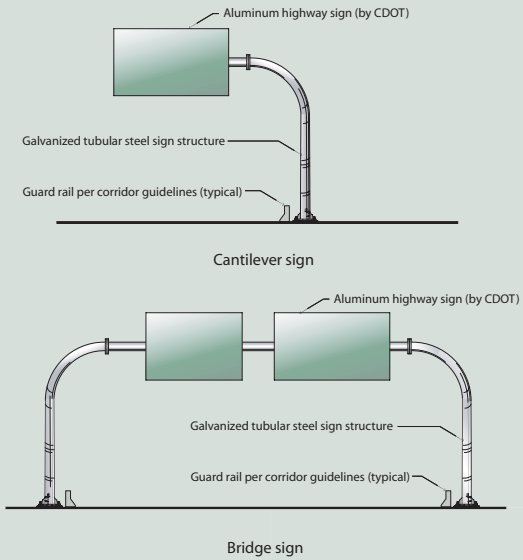

Standard light fixture

ADDITIONAL SITE AMENITIES

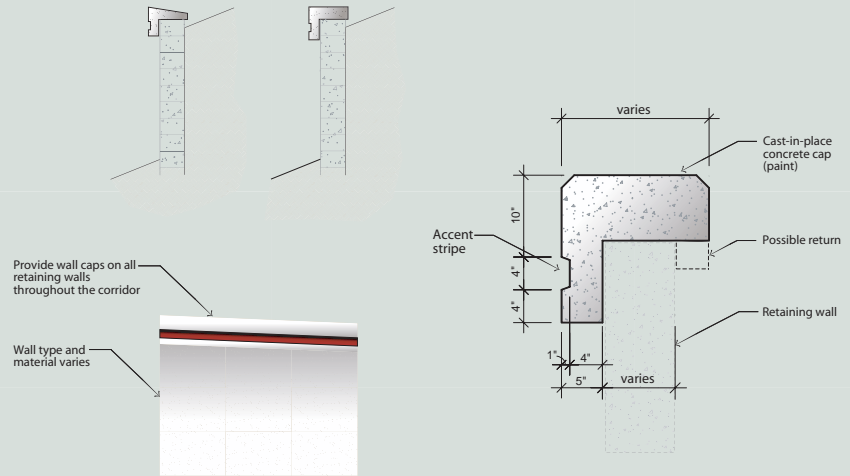

REQUIRED WALL CAP



PRECAST CONCRETE BLOCKS

Wall material
 Precast Concrete
 Cast-In-Place Concrete
 Concrete Masonry Units (concrete block)

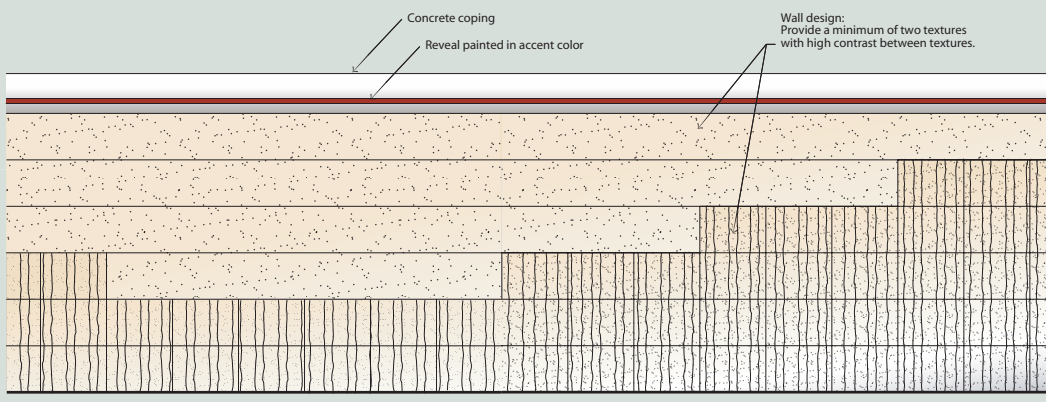

Recommended finishes for concrete masonry units (CMU)

Smoother textures

There are other semi-smooth textures available to use. It is strongly recommended that any smooth block areas be kept to a bare minimum. Completely smooth areas can show construction defects more readily.

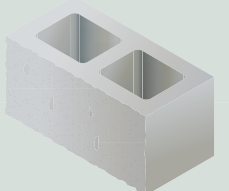

Split-Face CMU

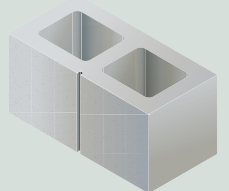

Split-Face with single mortar groove CMU

Coarser textures

There are other coarse textures available to use. The design intent is to use CMU of varying face depths to generate contrasting textures and shadows at a highway scale.

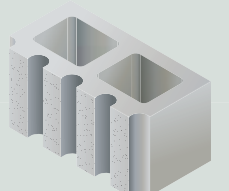

Four Post CMU

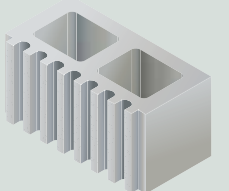

Eight Post CMU



ENHANCED CONSTRUCTION

WALL MATERIAL
 Precast Concrete
 Cast-In-Place Concrete
 Concrete Masonry Units (concrete block)

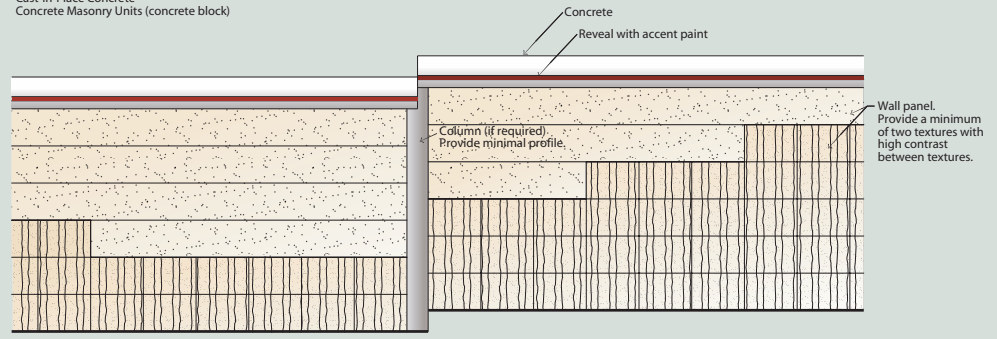

Recommended finishes for precast concrete or cast-in-place concrete

Smoother textures
 There are other semi-smooth textures available to use. It is strongly recommended that any completely smooth areas be kept to a bare minimum. Completely smooth areas can show construction defects more readily.

Coarse textures
 There are other coarse textures available to use. The design intent is to use a texture that has a relief of 1 1/2".

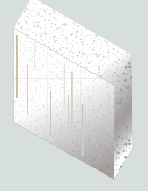

Coarse Sandblast (similar to Scott Systems Formliner, sandblast No. 3, #121 or equal)

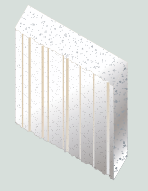

Hammered Finish (similar to Scott Systems Formliner, bush hammer, #162 or equal)

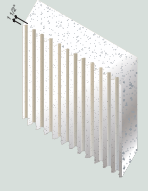

Fractured Fin (similar to Scott Systems Formliner, Cleveland flute, #101 or equal)

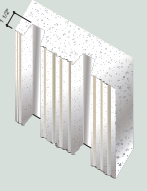

Colorado Drag (similar to Scott Systems Formliner, Colorado Drag aggregate #145 or equal)

WALL CONSTRUCTION ■ DETAILS

C-470 CORRIDOR PROJECT

