

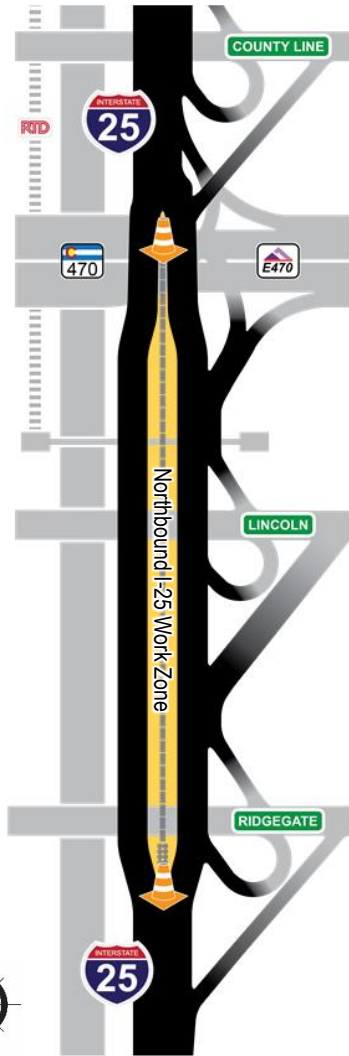

# Northbound I-25 Temporary Traffic Split Travel Paths

The two left lanes will be split from the rest of northbound I-25 to make room for a temporary work zone. Though traffic headed north of County Line should use the two left lanes.



Lincoln, C-470/E-470 and County Line exit traffic must be in the two right lanes by RidgeGate. No off-ramp access from two left lanes between RidgeGate and County Line.

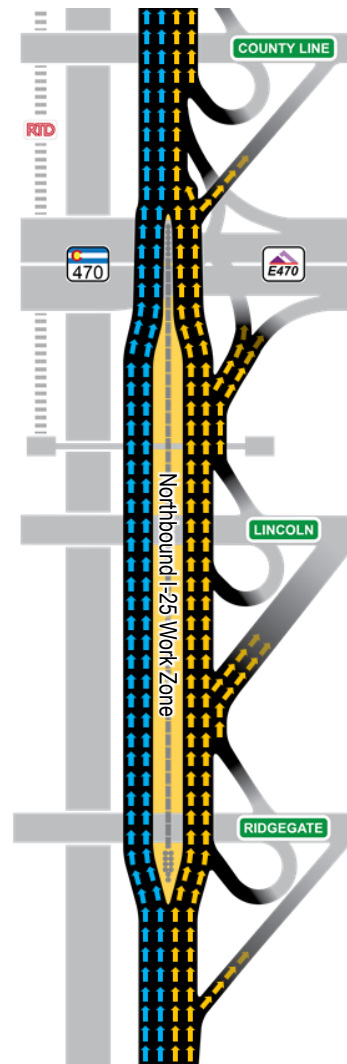

On-ramp traffic enters as usual and merges with the rest of I-25 north of the County Line off-ramp.

