



To Schedule RSS please call 970-667-1005 or visit [us34canyon.codot.gov](http://us34canyon.codot.gov). Below is a step by step guide for submitting a request online.

**US 34 Big Thompson Canyon**

**US 34 Canyon Closed Through Memorial Day Weekend**

US 34 will be closed with no through access from mile points 80 (Cedar Cove) to 72 (just west of Waltonia) until just before Memorial Day weekend 2018. Scheduled residential access is allowed with permits only.

A two-mile stretch of US 34 west of Drake remains closed to all motorists; travelers on US 34 will use Larimer County Road 43 to travel from Loveland to Estes Park.

[Why has the road been closed?](#)

- Permits for Residents**
- Overview of Resiliency Measures Being Made
- Plan to Cut Nearly Two Years off Construction
- Project Background

**Permits for Residents**

Please call 970-667-1005 to schedule an appointment to get a permit for access during the closure.

- You're allowed one permit per vehicle.
- Permits provide through access on US 34 from MP 67 to MP 83 from 6-8:30 a.m., and from 4-7 p.m. throughout the closure.
- Permit holders should plan for delays as pilot cars lead vehicles in both directions through the 13-mile work zone.
- Crews are scheduled to work seven days a week to meet the aggressive schedule.
- \*Canyon residents are defined as those living along US 34 between Mall Road and the Dam Store along County Road 43 up to Glen Haven.**
- When the work zone is closed**, the only vehicles permitted to travel through it are emergency service vehicles and, at specific times of the day, people who live in the canyon or are doing business in the canyon.
- During snow events, drivers using the US 36 detour route between Lyons and Estes Park must follow [snow chains](#) for passenger vehicles or chain laws for commercial vehicles.

[Access the Resident Scheduling Service.](#)

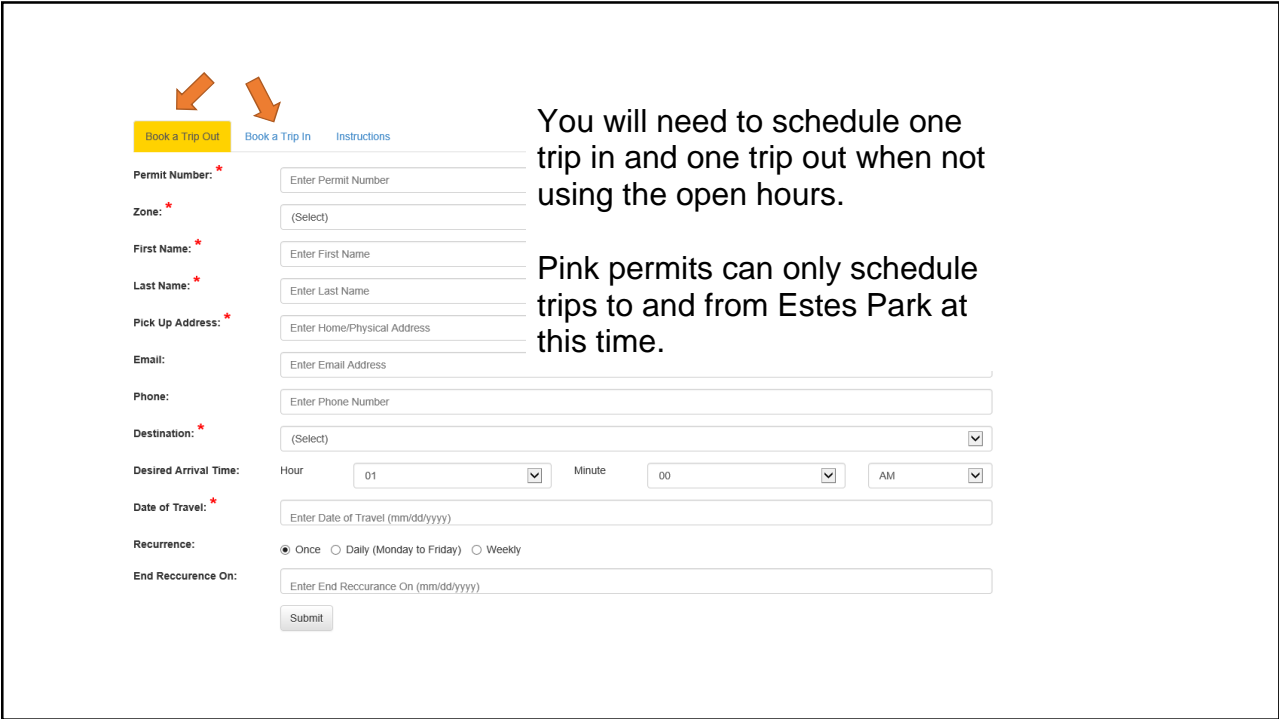
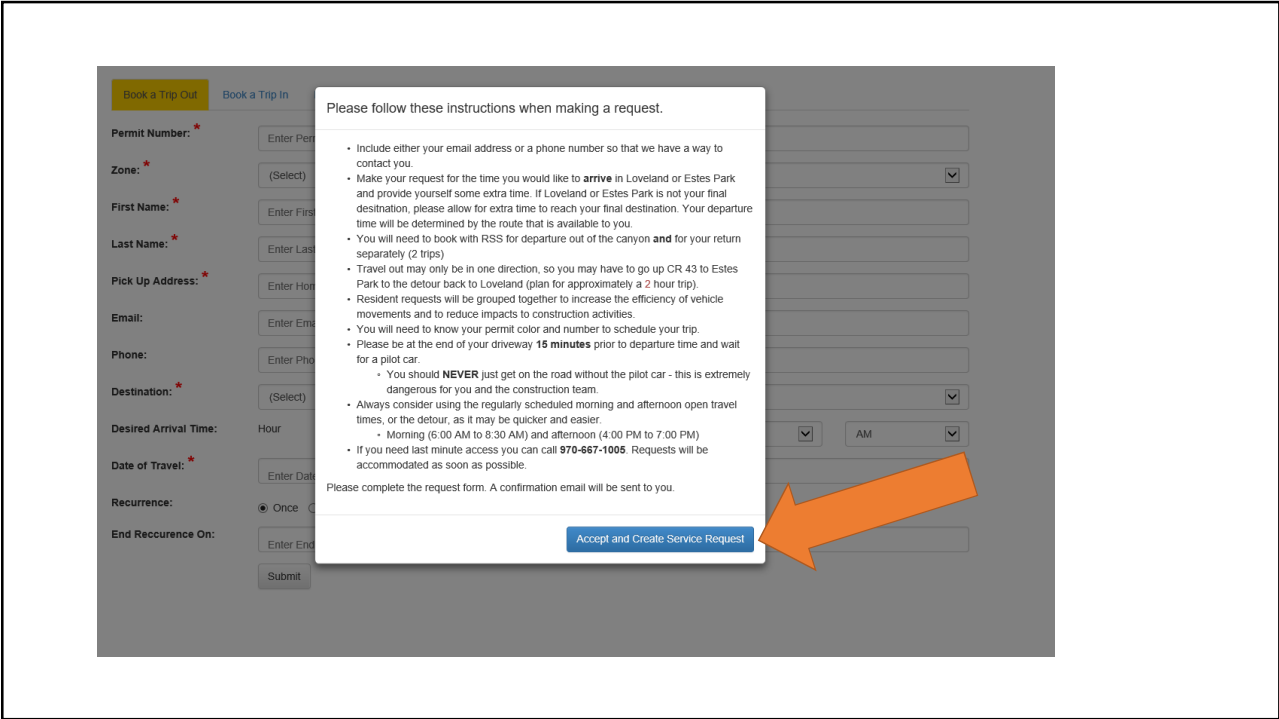

<b>Permit Number: *</b>	<input type="text" value="Enter Permit Number"/>	<b>Fill in all fields, including contact information. Email is preferred, but include a phone number if you do not have email.</b>	<input type="text"/>
<b>Zone: *</b>	<input type="text" value="(Select)"/>		<input type="text"/>
<b>First Name: *</b>	<input type="text" value="Enter First Name"/>	<b>You will be assigned to a time that works best with all of the other requests and the current work. This time will be sent in a confirmation email, 24 hours in advanced.</b>	<input type="text"/>
<b>Last Name: *</b>	<input type="text" value="Enter Last Name"/>		<input type="text"/>
<b>Home Address: *</b>	<input type="text" value="Enter Home Address"/>	<input type="text"/>	
<b>Email:</b>	<input type="text" value="Enter Email Address"/>	<input type="text"/>	
<b>Phone:</b>	<input type="text" value="Enter Phone Number"/>	<input type="text"/>	
<b>Where would you like to be picked up: *</b>	<input type="text" value="(Select)"/>	<input type="text"/>	
<b>Desired Pick-Up Time: *</b>	Hour <input type="text" value="01"/> <input type="text" value="Minute"/> <input type="text" value="00"/> <input type="text" value="AM"/>	<input type="text"/>	
<b>Date of Travel: *</b>	<input type="text" value="Enter Date of Travel (dd/mm/yyyy)"/>		
<b>Recurrence:</b>	<input checked="" type="radio"/> Once <input type="radio"/> Daily (Monday to Friday) <input type="radio"/> Weekly		
<b>End Recurrence On:</b>	<input type="text" value="Enter End Recurrence On (mm/dd/yyyy)"/>		
	<input type="button" value="Submit"/>		