

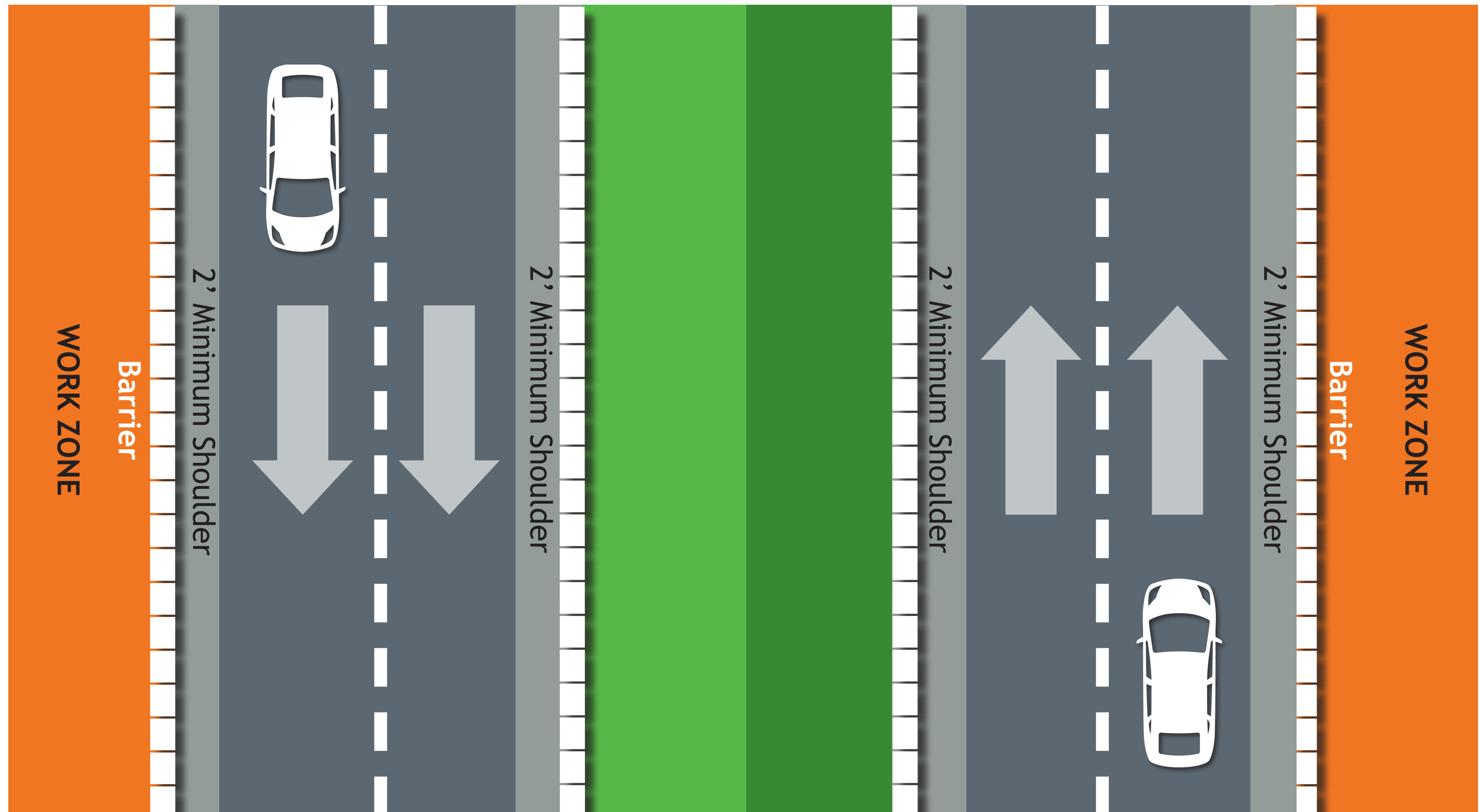

# I-25 South Gap Project Monument–Castle Rock

## South Section : Phase 1 *County Line Road to Greenland Road*

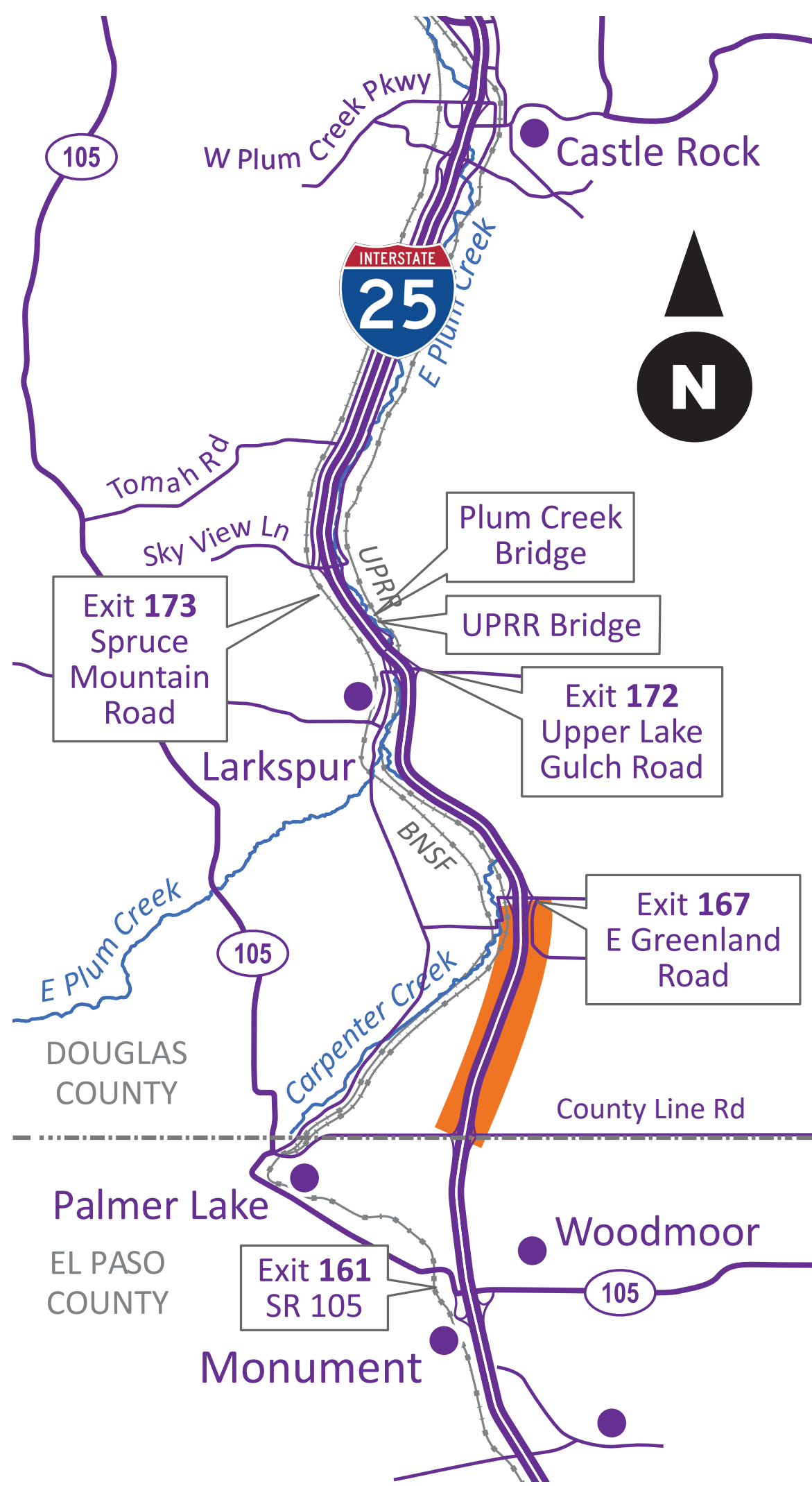

- Construction Activities**
- Outside widening, earthwork and asphalt
  - Storm sewer pipe
  - Wildlife crossing at MP 164.1 (½ of structure)
  - Temporary pavement to accommodate traffic





# I-25 South Gap Project Monument–Castle Rock

## South Section : Phase 2 *County Line Road to Greenland Road*

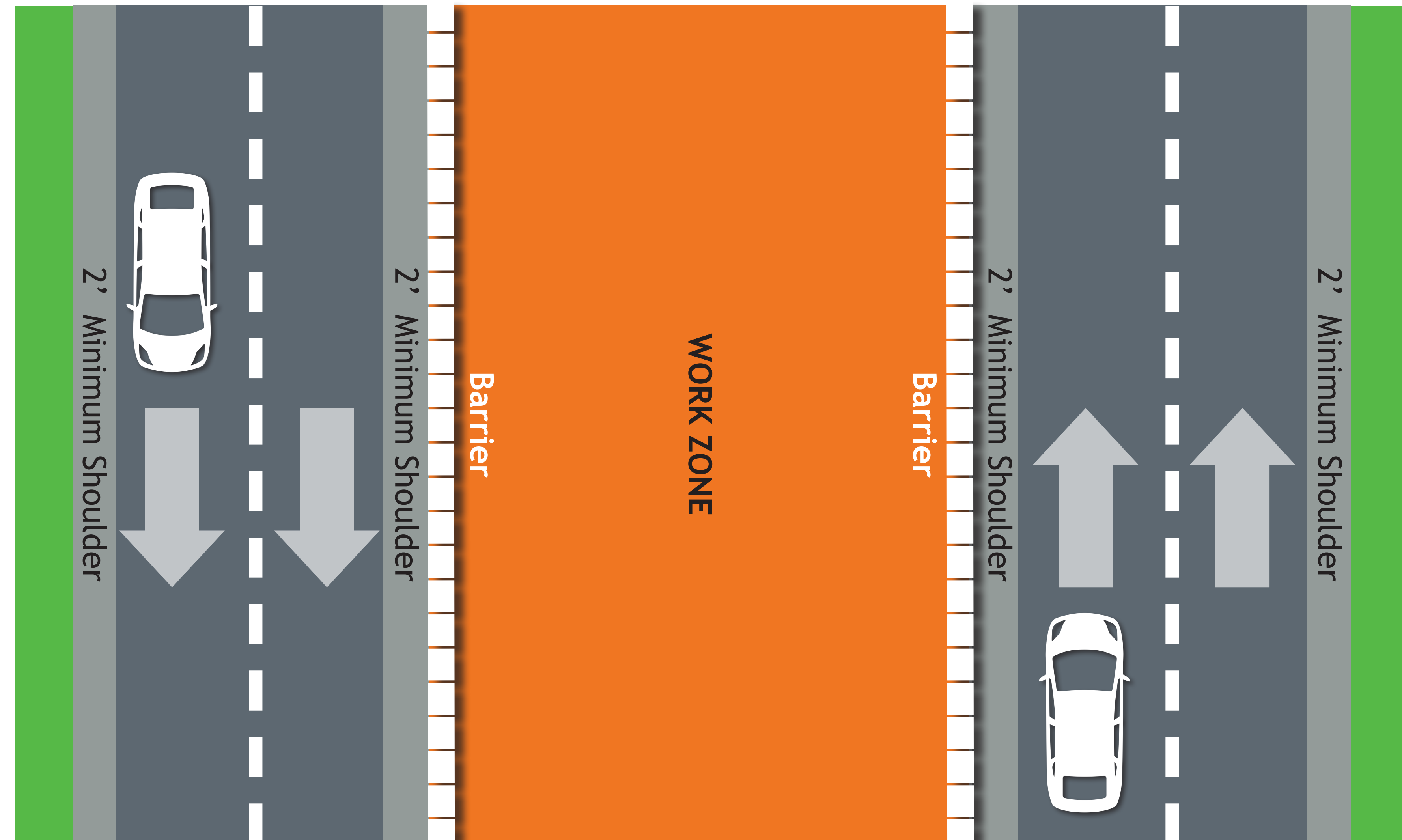
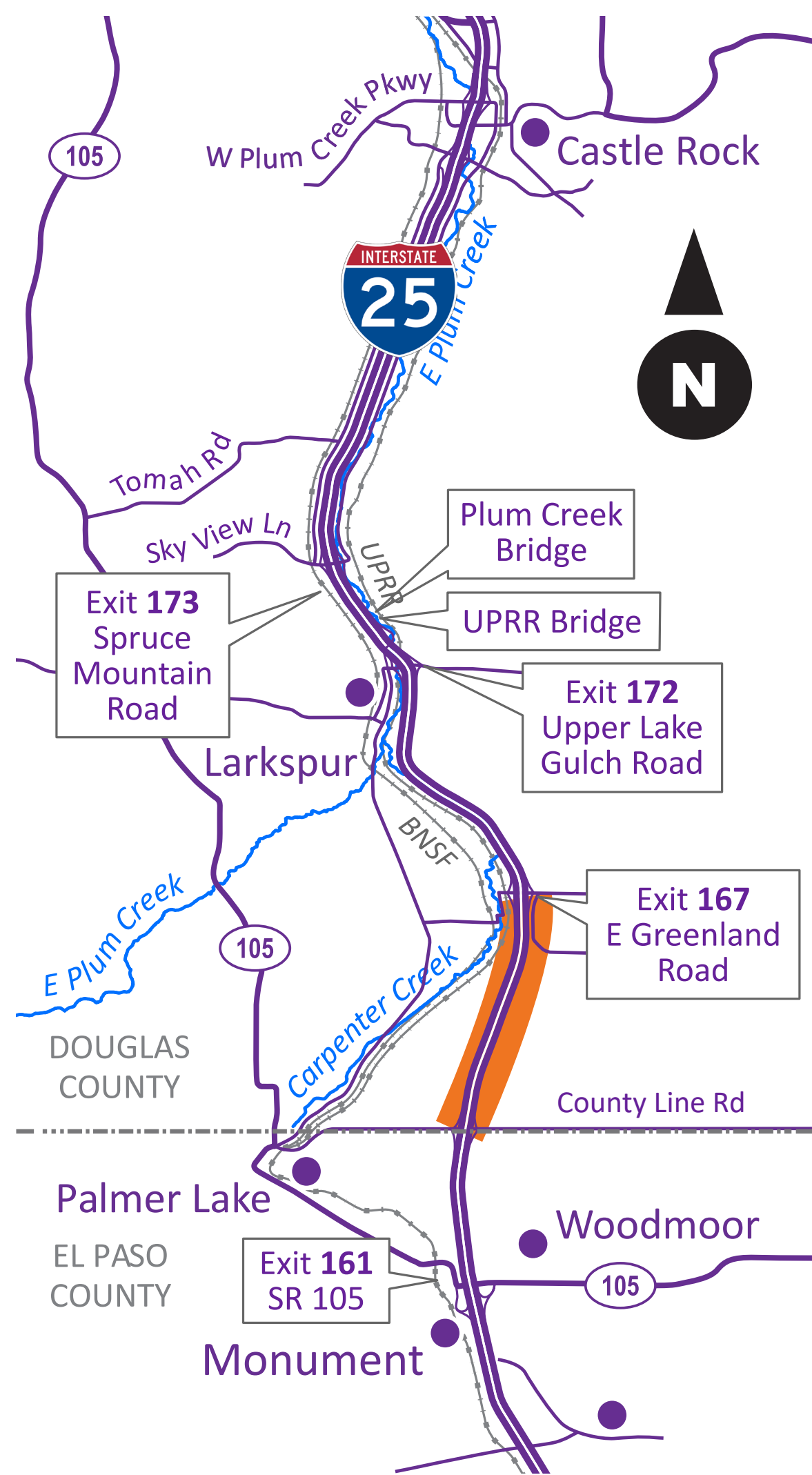

- Construction Activities**
- Inside widening, earthwork and asphalt
  - Storm sewer pipe
  - Wildlife crossing at MP 164.1 (½ of structure)
  - Median barrier and retaining walls

