

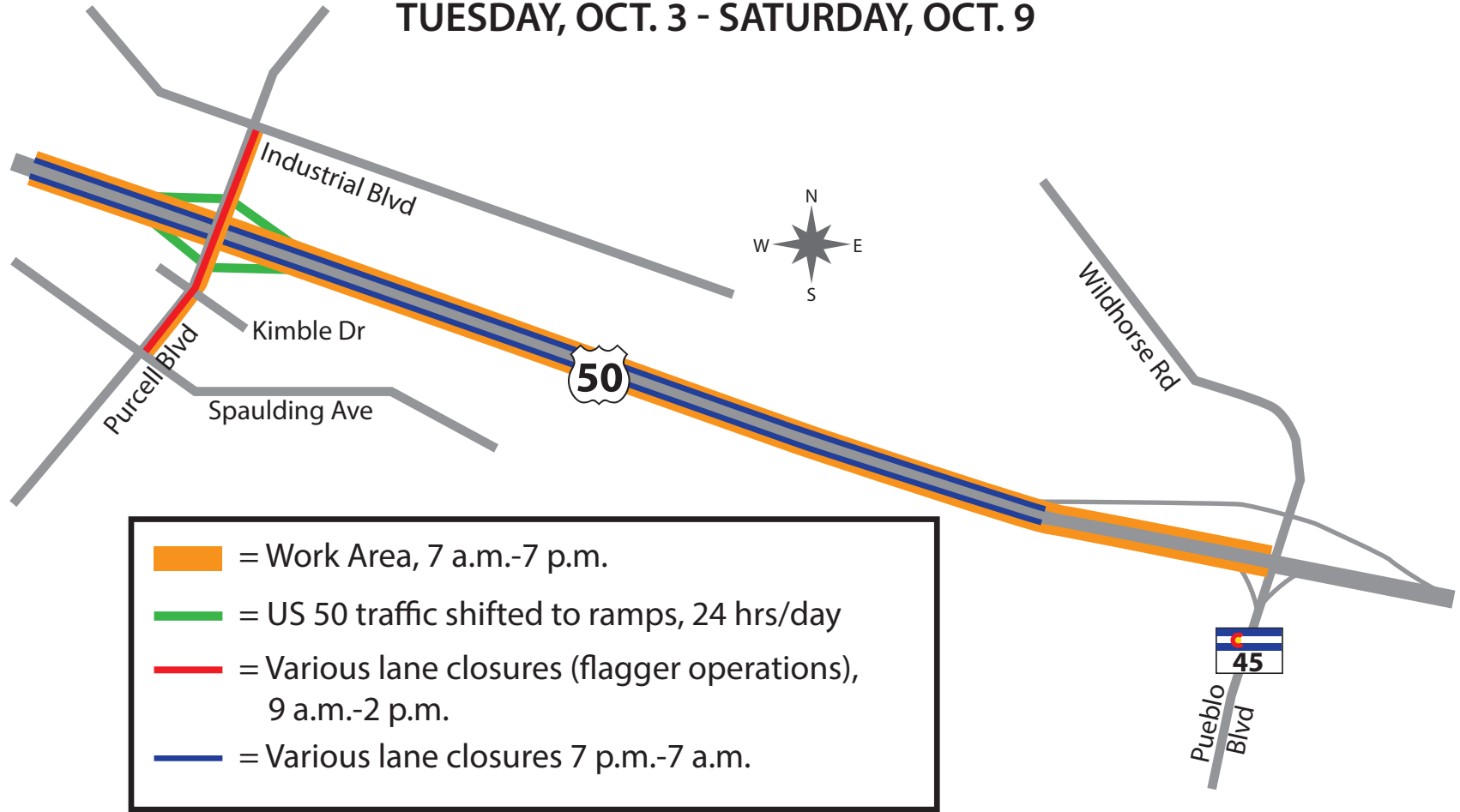



TUESDAY, OCT. 3 - SATURDAY, OCT. 9



-  = Work Area, 7 a.m.-7 p.m.
-  = US 50 traffic shifted to ramps, 24 hrs/day
-  = Various lane closures (flagger operations), 9 a.m.-2 p.m.
-  = Various lane closures 7 p.m.-7 a.m.