



Traffic switch on US 85 scheduled for August 12

Expect delays and crews on the roadway

PROJECT OVERVIEW

Starting Thursday, Aug. 12, at 6:00 p.m., crews will work to realign northbound and southbound lanes of US 85 between mile posts 194.25 and 191.75 (north of Kelley Ave./Kelly Ct. to north of Delva Way). Motorists can expect lane shifts, striping crews, signal work, and flaggers on the roadway. The traffic switch is needed to prepare for work on the new concrete roadway for Phase 2 this fall and will remain in place until completed.

In addition, the intersection of US 85 and Airport Road will be closed for reconstruction, starting Thursday, Aug. 12 at 6:00 p.m. and through the weekend, opening on Monday, Aug. 16 by 5:00 a.m. There will be a detour in place with flaggers to access Airport Road as shown in green on the map to the right.

The southbound detour will route motorists to Sedalia and then back to Airport Rd. and US 85 via Manhart Ave., then right to N. Plum Ave. (which becomes N. Peterson Rd.).

The northbound detour will route motorists to Titan Rd. and then back to Airport Rd. and US 85 via Titan Rd., left to N. Moore Rd., left to Waterton Rd. (which becomes Airport Rd.).

For the safety of motorists and workers, drivers are reminded to obey all posted speed limits through the project. Reduced lane widths and reduced speed limit of 45 mph will be in effect until further notice.

Castle Rock Construction of Colorado, LLC. is the prime contractor for this project.

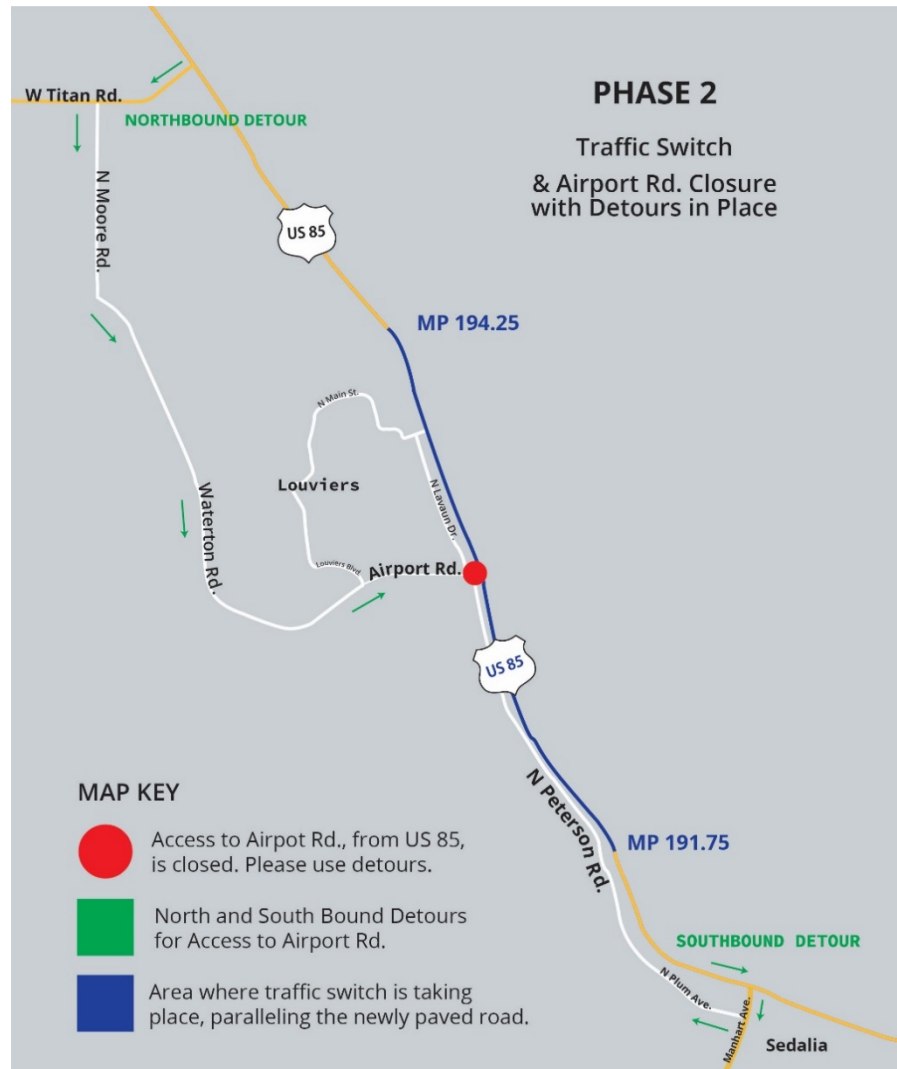



COLORADO
Department of Transportation

TRAVEL IMPACTS

- Daytime work hours range from 7:00 a.m. to 7:00 p.m. Monday through Friday. Expect night work Aug. 12-16, 7:00 p.m. to 7:00 a.m., as crews work continuously throughout the weekend.
- Vehicles are reduced to a single lane in both directions for the duration of the 2021 construction season. Motorists should expect flaggers on the roadway to help guide them through the construction zone or when work is near intersections.
- The speed limit is reduced to 45 mph, and work zone fines are doubled. Motorists should plan for possible traffic delays.

CONTACT INFORMATION

If you have questions or concerns or if you would like to be added to our public outreach contact list to receive construction updates, please contact us!

Phone: 720.356.4400

Email: us85widening@gmail.com

Project Webpage: <https://www.codot.gov/projects/us85-widening-louviers>

