

Federal Highway Safety Improvement Program (HSIP) Local Agency Application (submit applications to Regional Traffic Engineer)

Requesting Agency: Mesa County

Submitted By:

Title:

Email:

Phone:

Date: April 29, 2016

(All fields required unless otherwise noted)

1) **Location** (Road Number, Street, Milepost, etc.):

Various (see attached map)

2) **Documented crash history** (if available, otherwise CDOT Crash Database will be used for evaluation using the most recent available three to five years of crash data):

See attached spreadsheet

3) **Traffic volume counts** (All directions/approaches, if available):

See attached map

4) **Description/Illustration of existing safety concern** (Photos Recommended):

Crashes occurring at various rural intersection due to either running the stop sign or failing to yield

5) **Description/Illustration of proposed improvement and the extent to which it addresses the crash problem:**

Advanced warning signs for intersection stops, intersection crossroad identification and advanced pavement markings with stop bars

- 6) **Amount of HSIP funding requested for proposed safety improvement** (90% Federal portion only, not including state/local 10% match)*:

89,834

*CDOT will provide 10% match on projects located along state highway system. Local agencies to provide match for projects that are located off the state highway system.

- 7) **Total estimated proposed safety improvement cost**
(Preliminary Cost Estimate Tabulation Recommended):

\$99,816^

^Benefit/Cost evaluation will be based off of this amount.

- 8) **Planned construction advertise date:**

July 2018

- 9) **Planned construction completion date:**

October 2018

Additional comments or notes regarding project or funding:

Design and Construction

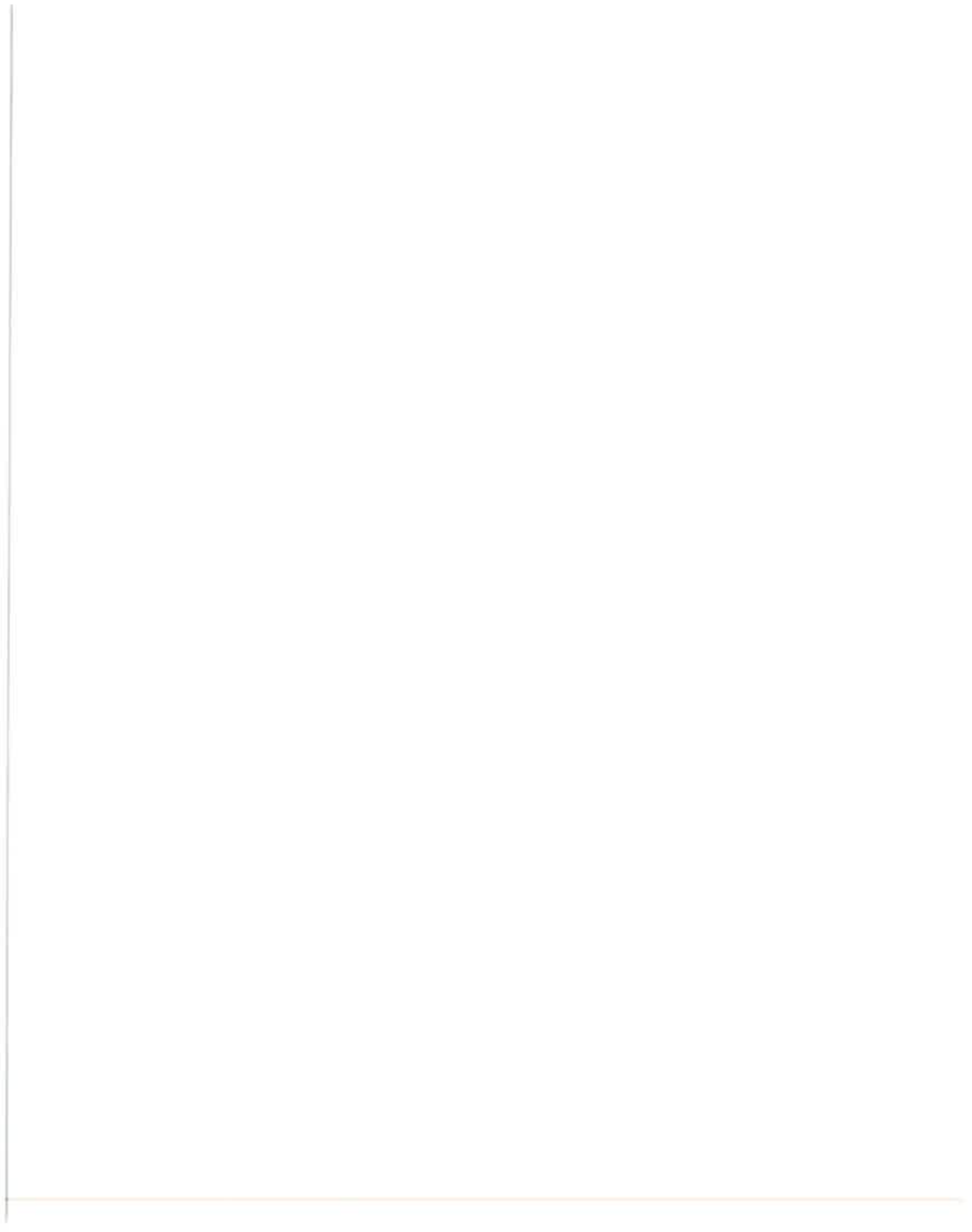
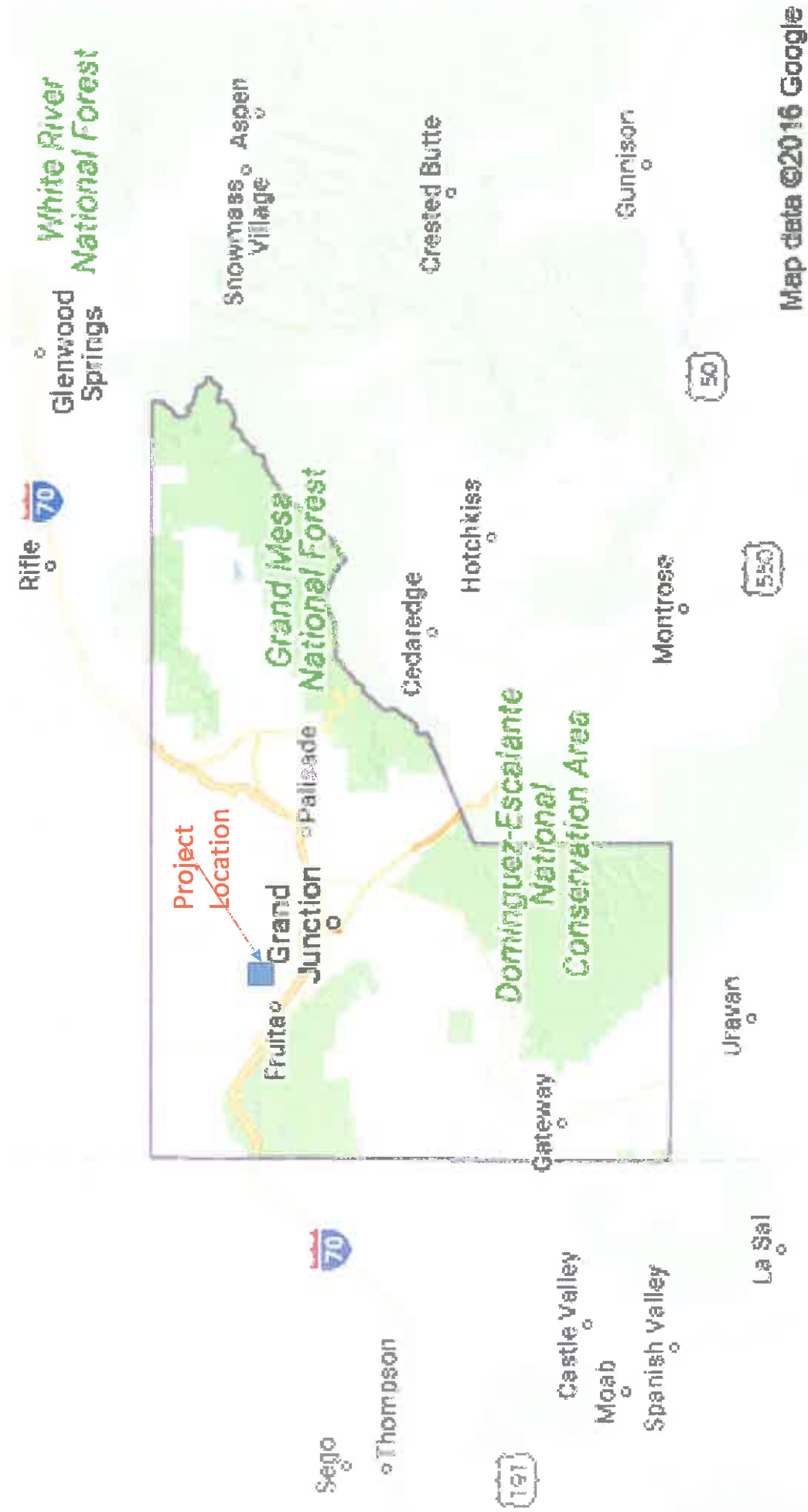

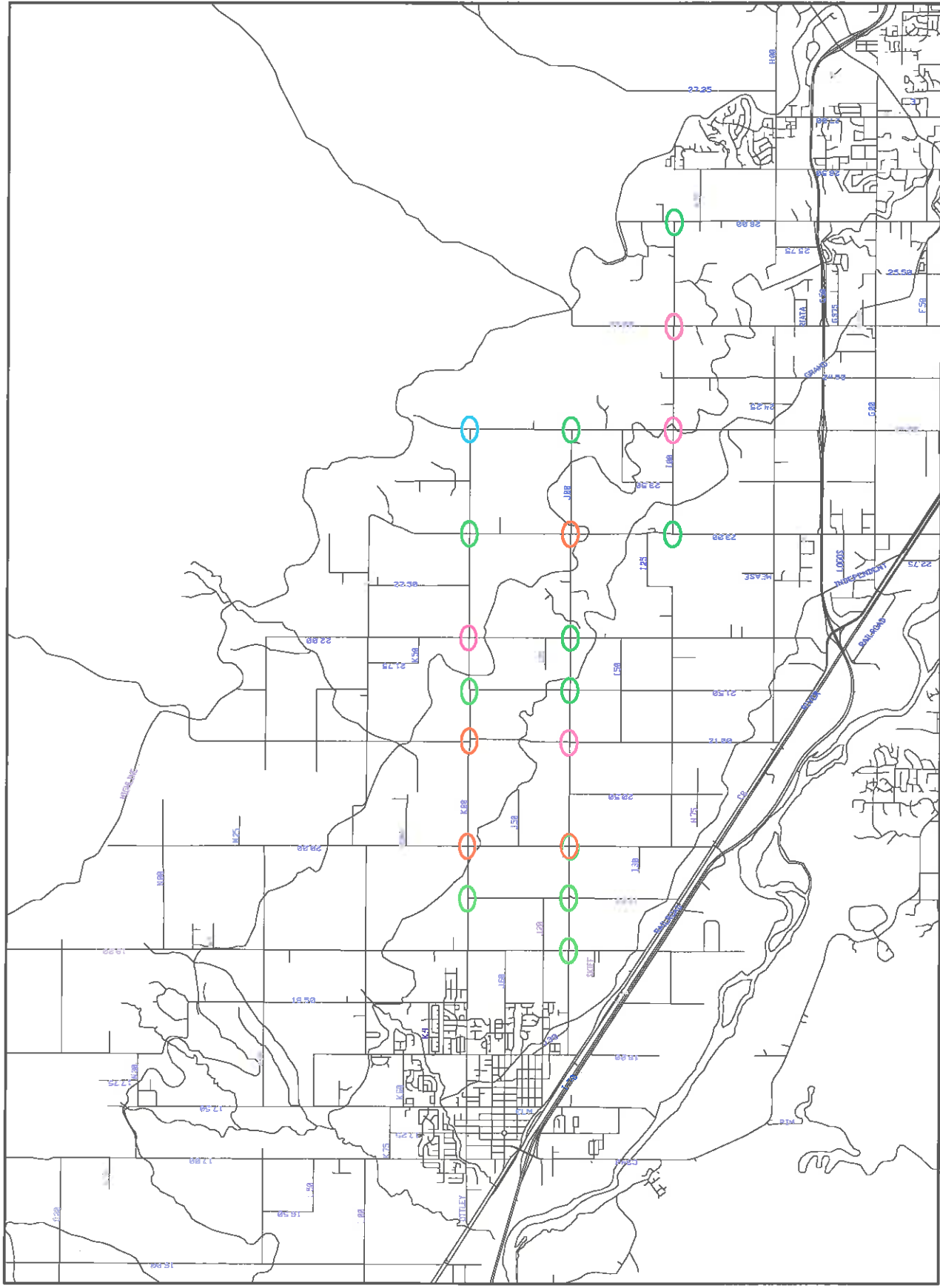

ACCIDENTS
11/15/16 10:22

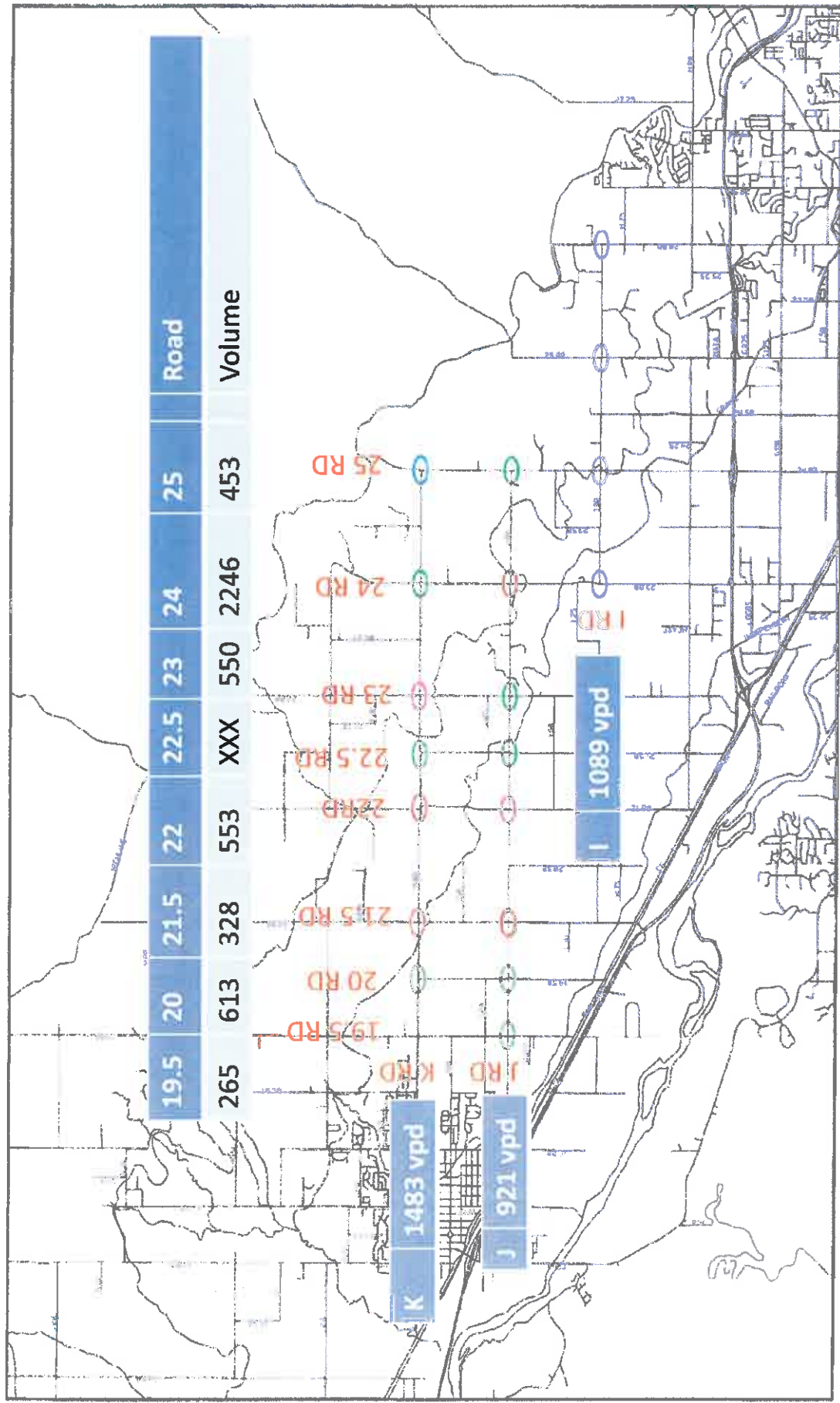

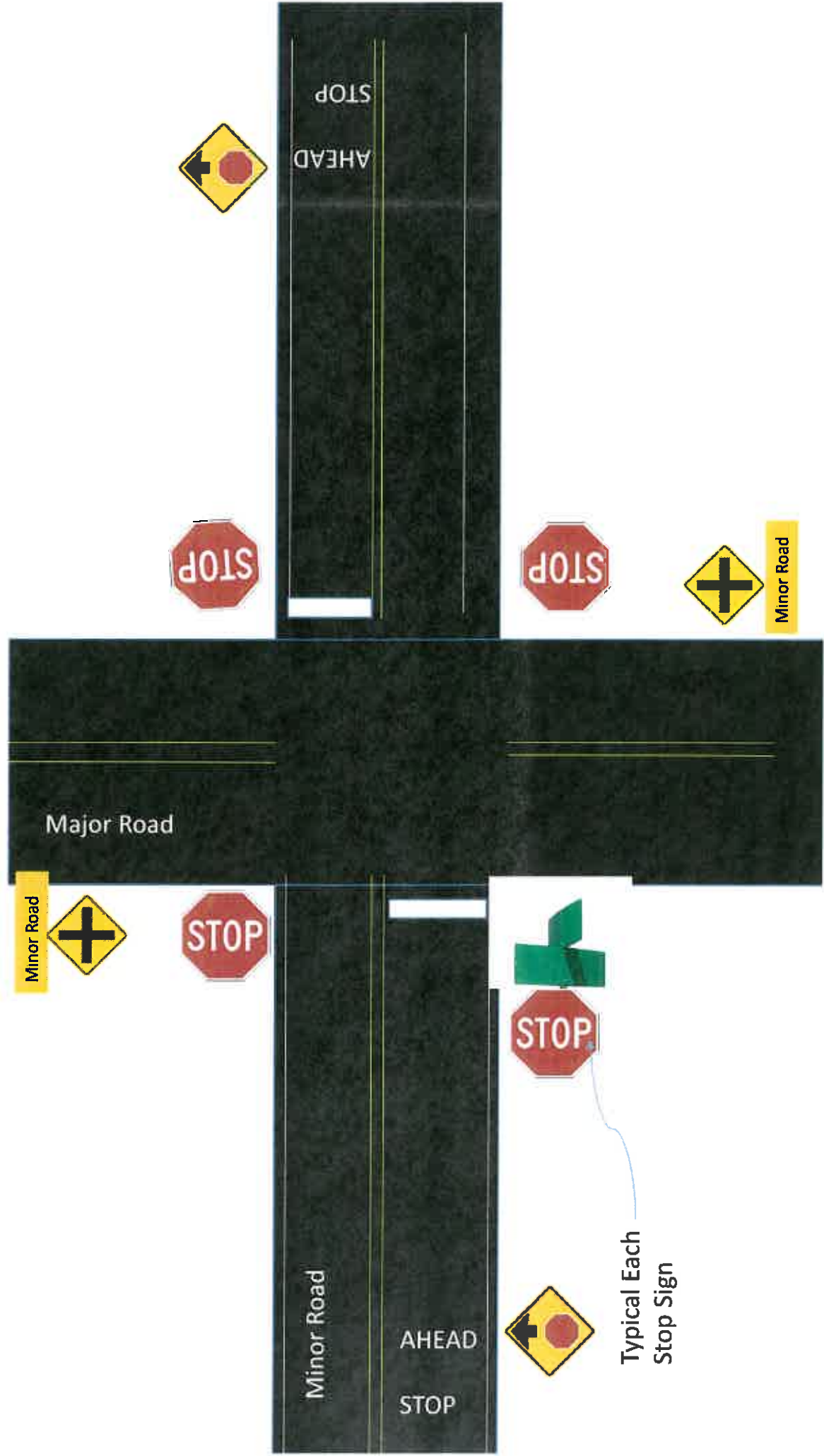

Typical Each Stop Sign

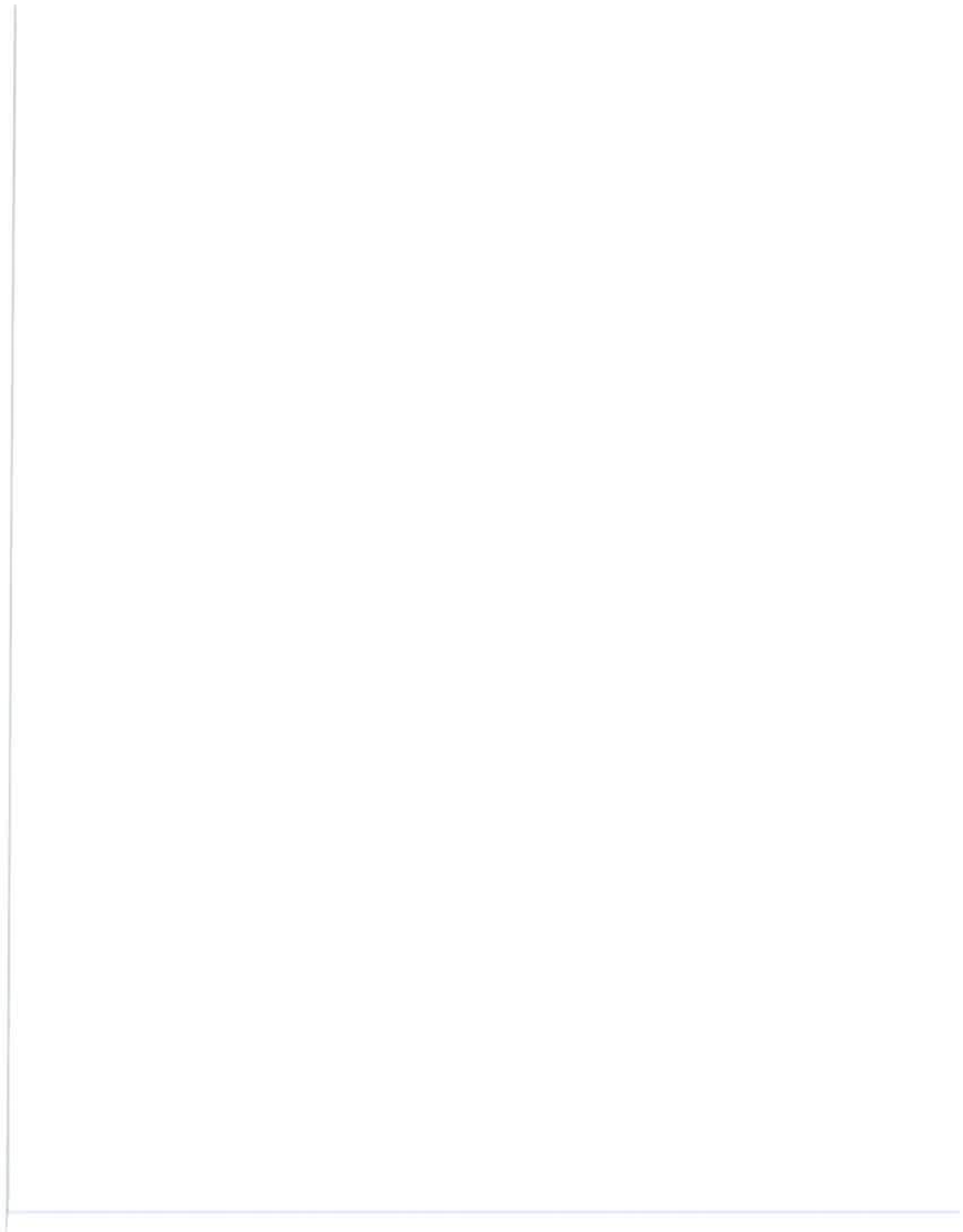

2008-2014

Mail Line	Cross street	PDO	Injury
K Road	19.5 Road		
K Road	20 road	3	1
K Road	21 Road	2	
K Road	21.5 Road		
K Road	22 Road	1	
K Road	23 Road	1	
K Road	24 Road		2

3# / FT

J road	19 road	1	
J road	19.5 Road		
J road	20 Road	3	2
J road	21 Road	2	
J road	21.5 Road		
J road	22 Road	1	1
J road	23 Road		1

J road 24 Road

3# / FT

I Road 23 Road

3

I Road 24 Road

3

2

I Road 25 Road

2

I road 26 Road

20

11