

**Case No. 1
Typical Application
Two-Lane Undivided Highway**

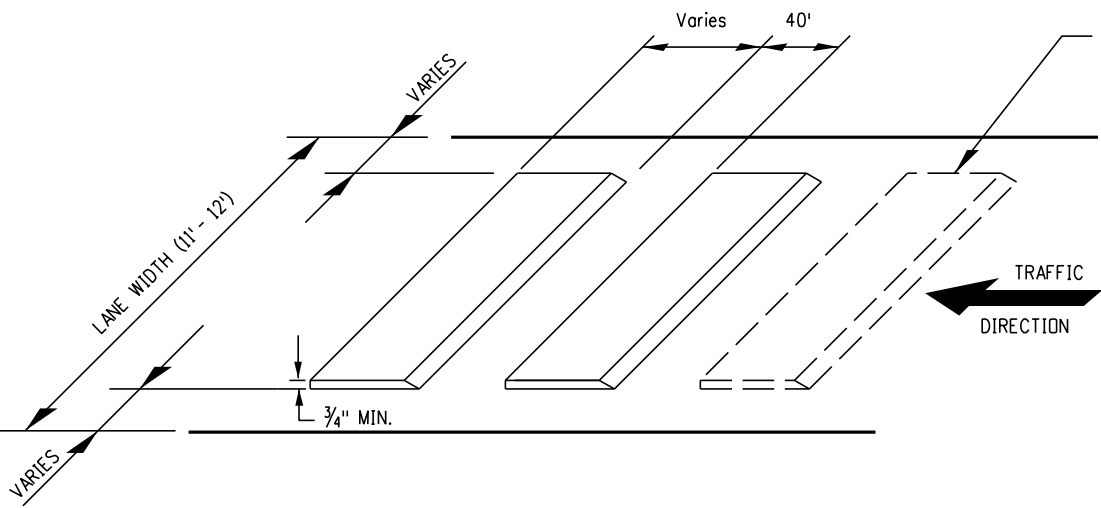

Detail - Temporary Portable Rumble Strip Array

OPTIONAL RUMBLE STRIP (SEE NOTE 10)

General Notes

1. Temporary portable rumble strip arrays shall be placed in advance of each flagging station when called for in the plans.
2. Temporary portable rumble strip arrays are used to supplement a series of advanced warning signs and shall be installed and removed when the signs are installed and removed.
3. Remove the temporary portable rumble strips prior to removing the advanced warning signs.
4. Lane widths should be maintained through work zone travel lanes wherever practical.
5. Do not use temporary rumble strips on slippery surfaces, such as wet or sandy pavement.
6. Do not use temporary rumble strips on horizontal curves.
7. Use temporary portable rumble strips on roadways with posted work zone speed limits of 75 mph or less.
8. For the lowest air temperature to apply the temporary portable rumble strips on road pavements, contact the temporary portable rumble strip manufacturer.
9. Install per manufacturer's recommendations.
10. Optional rumble strip to install, as directed by the Engineer.

Legend

- Channelizing device: for type of device to be used, see the schedule of construction traffic control devices included in plans.
 - Direction of travel
 - Flagger
 - Work area
- T = Termination taper = 100'
 S = Work zone speed limit
 W = Lane width
 L = Merging taper (S > 45 mph) = WxS
 L = Merging taper (S < 45 mph) = (WxS²)/60
 N = number of devices (L/S) + 1
 N = Number of devices at termination taper = 5 (min.)

*** Key to Advance Signing Distances**

ROAD TYPE	DISTANCE BETWEEN SIGNS (FT.)		
	A	B	C
URBAN (S < 45 MPH)	100	100	100
URBAN (S ≥ 45 MPH)	350	350	350
RURAL	500	500	500

Computer File Information	
Creation Date:	07/04/12
Created By:	KEN
Last Modification Date:	07/01/26
Last Modified By:	GLY
CAD Ver.:	ORD 10.12 Scale: Not to Scale Units: English

Sheet Revisions	
Date:	Comments

Colorado Department of Transportation
Traffic Safety & Engineering Services
 2829 West Howard Place
 Denver, CO 80204
 EB

Portable Rumble Strips (Temporary)
 Issued by the Traffic Safety & Engineering Services: July 01, 2026

Standard Plan No.
S-630-5
Standard Sheet No. 1 of 2
 Project Sheet Number:

TEMPORARY PORTABLE RUMBLE STRIP ARRAYS
(SEE DETAIL BELOW)

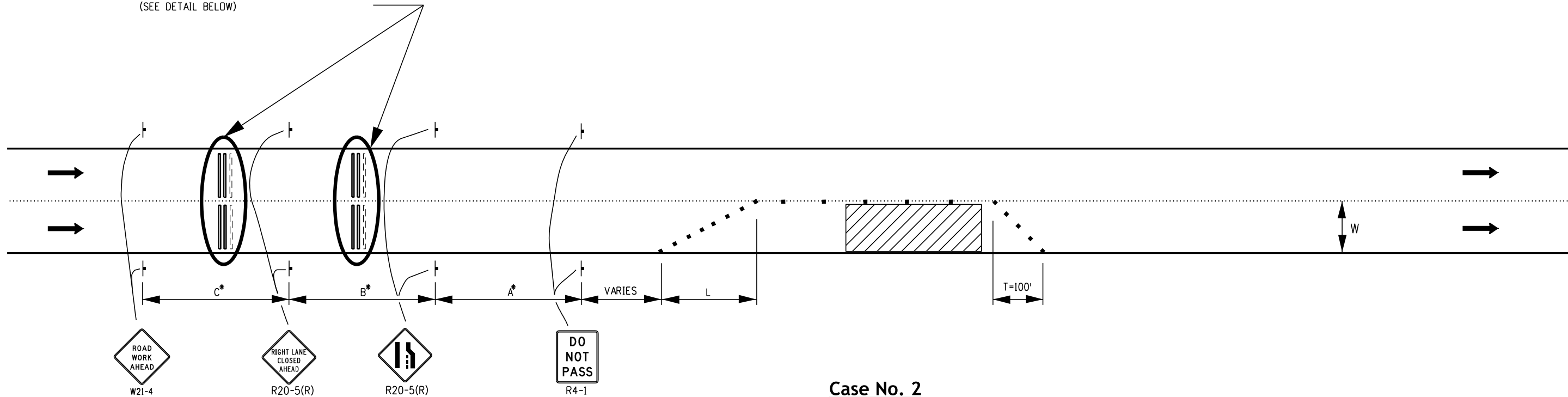

Case No. 2
Typical Application
Multi-Lane Divided Highway with Right Lane Closed

Legend

- ▣ Channelizing device: for type of device to be used, see the schedule of construction traffic control devices included in plans.
 - ➔ Direction of travel
 - ▨ Work area
- T = Termination taper = 100'
 S = Work zone speed limit
 W = Lane width
 L = Merging taper (S > 45 mph) = WxS
 L = Merging taper (S < 45 mph) = (WxS²)/60
 N = Number of devices (L/S) + 1
 N = Number of devices at termination taper = 5 (min.)

General Notes

1. Temporary portable rumble strip arrays are used to supplement a series of advanced warning signs and shall be installed and removed when the signs are installed and removed.
2. Remove the temporary portable rumble strips prior to removing the advanced warning signs.
3. Lane widths should be maintained through work zone travel lanes wherever practical.
4. Do not use temporary rumble strips on slippery surfaces, such as wet or sandy pavement.
5. Do not use temporary rumble strips on horizontal curves.
6. Use temporary portable rumble strips on roadways with posted work zone speed limits of 75 mph or less.
7. For the lowest air temperature to apply the temporary portable rumble strips on road pavements, contact the temporary portable rumble strip manufacturer.
8. Install per manufacturer's recommendations.
9. Optional rumble strip to install, as directed by the Engineer.

*** Key to Advance Signing Distances**

ROAD TYPE	DISTANCE BETWEEN SIGNS (FT.)		
	A	B	C
URBAN (S < 45 MPH)	100	100	100
URBAN (S ≥ 45 MPH)	350	350	350
RURAL	500	500	500
EXPRESSWAY/FREEWAY	1,000	1,500	2,640

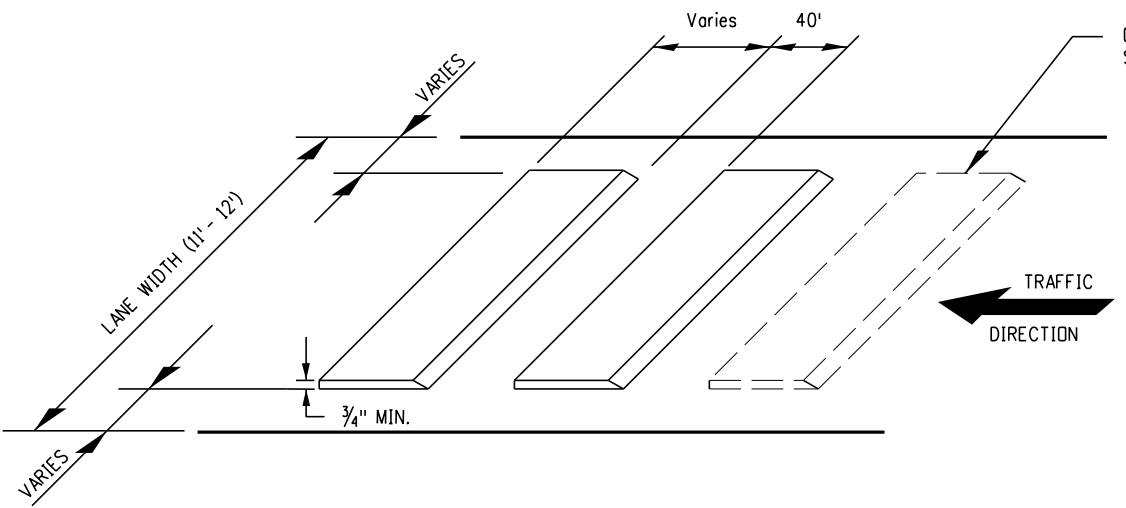

Detail - Temporary Portable Rumble Strip Array

Computer File Information	
Creation Date:	07/04/12
Created By:	KEN
Last Modification Date:	07/01/26
Last Modified By:	GLY
CAD Ver.:	ORD 10.12 Scale: Not to Scale Units: English

Sheet Revisions	
Date:	Comments

Colorado Department of Transportation
Traffic Safety & Engineering Services
 2829 West Howard Place
 Denver, CO 80204
 EB

Portable Rumble Strips (Temporary)
 Issued by the Traffic Safety & Engineering Services: July 01, 2026

Standard Plan No.
S-630-5
Standard Sheet No. 2 of 2
 Project Sheet Number: