



# I-25 South Gap Project Monument–Castle Rock

## Southbound I-25 Chain-Up Station Near Larkspur

### PROJECT OVERVIEW

The Colorado Department of Transportation is providing a temporary chain-up station along southbound I-25, about halfway between Castle Rock and Monument, in the I-25 South Gap construction zone.

This 1,000-foot area will be protected by concrete safety barrier and provide room for up to 8 semi-trucks to chain up at one time, before heading over Monument Hill toward Colorado Springs. This area is designed as a temporary chain-up opportunity only. Long-term or overnight parking is not permitted.

#### When will the chain-up station be operational?

This temporary chain-up station is in place as of November 2020 and will be open while the chain law is in effect for travel over Monument Hill.

#### Will there be signs for the chain-up station?

Yes. Truckers should watch for orange signs designating the chain-up station, starting just south of Castle Rock (MP 181).

#### Will the chain-up station have lights?

Yes. Truckers can expect two temporary light towers along the chain-up station. Still, truckers are advised to always be prepared with their own flashlights or headlamps for utmost safety.

#### With the chain-up station being located next to mainline I-25 traffic, will speed limits along I-25 be reduced during inclement weather?

Yes. The I-25 South Gap project has installed several portable variable speed limit signs throughout the corridor and can lower speed limits between MP 181 and MP 161 during winter weather, crashes or major construction activities.

#### How will the chain-up station be separated from mainline I-25 traffic?

A concrete barrier will separate the chain-up station from I-25 traffic, protecting truckers as they chain-up. Truckers can also expect CDOT to remove snow from the chain-up station during winter weather.

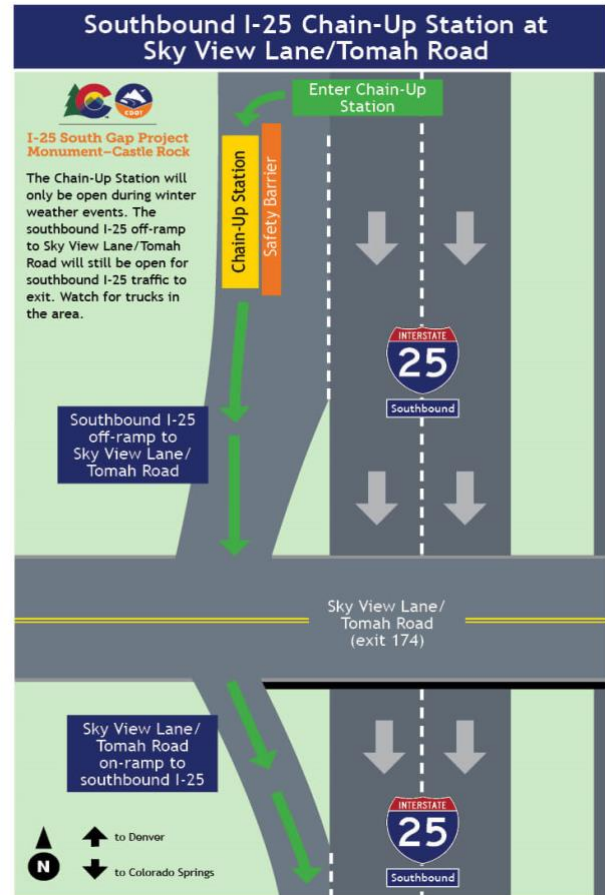



# I-25 South Gap Project Monument–Castle Rock

## How will the merge at Sky View Lane/Tomah Road work with other traffic?

The I-25 South Gap project is widening I-25 between Castle Rock and Monument. About half of the total paving work is completed. Approaching Sky View Lane/Tomah Road, new pavement gives room for both the chain-up station and an exit ramp. All motorists are being asked to pay extra attention at this ramp. (Generally, traffic volume from motorists exiting here is fairly low.) Truckers will use the southbound on-ramp to get back on southbound I-25.

## What is the I-25 South Gap project?

CDOT is improving 18 miles of I-25 between Monument and Castle Rock by widening the highway from two to three lanes in each direction. The new lane will operate as an Express Lane, allowing motorists the choice of taking the Express Lane for a faster, more reliable travel time in exchange for a toll. Express Lanes will be free to vehicles with three or more people and motorcycles. All travelers will have the choice of taking the general-purpose lanes for free.

The project also includes shoulder widening, rebuilding bridges, new wildlife crossings, resurfacing with new pavement and modernizing technology. Project completion is scheduled for 2022.

## CONTACT INFORMATION

If you have questions or concerns about the I-25 South Gap Project, or if you would like to be added to our public outreach contact list to receive construction updates, please contact us!

Phone: (720) 745-5434

Email: [i25gap@codot.us](mailto:i25gap@codot.us)

Project Webpage: [i25gap.codot.gov](http://i25gap.codot.gov)

Project Facebook: [Facebook.com/I25SouthGapProject](https://www.facebook.com/I25SouthGapProject)

